

# Republic of Ireland Price List March 2025

Prices effective from 3rd March 2025



# Contact us



## Customer Support Centre

To place an order or for a price enquiry  
please contact:

Email: [customersupportcentre@rockwool.com](mailto:customersupportcentre@rockwool.com)  
Telephone: 00 44 1656 868 400

### Opening Times

|           |               |
|-----------|---------------|
| Monday    | 6.30am-6.30pm |
| Tuesday   | 6.30am-6.30pm |
| Wednesday | 6.30am-6.30pm |
| Thursday  | 6.30am-6.30pm |
| Friday    | 6.30am-5.30pm |

## Technical Solutions

For all technical product and application  
queries please contact:

Email: [technical.solutions@rockwool.com](mailto:technical.solutions@rockwool.com)  
Telephone: 00 44 1656 868 490

### Opening Times

|           |         |
|-----------|---------|
| Monday    | 9am-5pm |
| Tuesday   | 9am-5pm |
| Wednesday | 9am-5pm |
| Thursday  | 9am-5pm |
| Friday    | 9am-4pm |

# Full load pallet quantities

To assist with load building, we have outlined below how many pallets comprise a full load for each of the available pallet sizes. Depending upon the pallet size and product, the number of pallets in a full load will vary, we have outlined below the details for these.

## Pallet Size: 1200 x 1200mm

FULL LOAD = 22 PALLETS

- Angle Fillet
- Cladding Roll
- DuctSlab
- DuctWrap
- Fire Barrier EN
- Flexi®
- Full Fill Cavity Batts
- High Performance Partial Fill Cavity Slab
- NyRock® Cavity Slab 032
- NyRock® Frame Slab 032
- RainScreen Duo Slab®
- Roll
- Rollbatt
- RWA45
- RW3
- Steel Frame Slab
- Timber Frame Slab
- Twin Roll

FULL LOAD = 42 PALLETS

- FirePro® Ablative Coated Batt

## Pallet Size: 1300 x 1200mm

FULL LOAD = 40 PALLETS

- SCB (sizes marked with \* only)

## Pallet Size: 2400 x 1200mm

FULL LOAD = 22 PALLETS

- HardRock® UB34
- High Impact Soffit Slab
- RW4 (Plain)
- RW5 (Plain)
- NyRock® RainScreen 032

## Pallet Size: 1200 x 1000mm

FULL LOAD = 52 PALLETS

- Acoustic Infill
- HardRock® Multi-Fix (DD)
- HardRock® Multi-Fix Recovery Board
- RockFloor®
- RockLap H&V Pipe Section

## Pallet Size: 2000 x 1200mm

FULL LOAD = 26 PALLETS

- Fire Duct Slab (Foil Faced)
- DuctRock® Slab
- SP FireStop EN
- BeamClad®
- RW4 (Foil/Tissue Faced)
- RW5 (Foil/Tissue Faced)
- RW6 (Foil/Tissue Faced)
- Soffit Slab

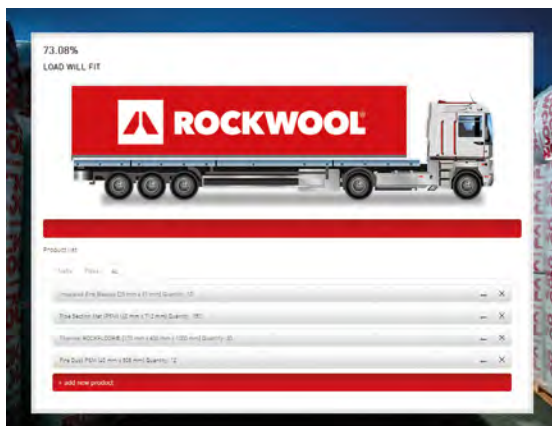

## Indicative Load Calculator

The Load Calculator forms part of the ROCKWOOL full service offering to make product selection and transportation quicker and easier, providing support to build your loads, ensuring all requirements are able to fit on the vehicle.

Try it for yourself at:

[www.rockwool.com/uk/loadcalc](http://www.rockwool.com/uk/loadcalc)



# Helping you meet demand



We are continuing to invest in logistics at ROCKWOOL to ensure that you receive the best possible service - that means getting you what you need, when you need it.

Some of our latest improvements include:

- The ROCKWOOL National Logistics Centre, a dedicated and expert hub for our inward and outbound logistics including a 60,000m<sup>2</sup> hard stand to help mobilise stock faster.
- An upgraded fleet, including branded artc and rigid vehicles for local and specialist deliveries. Whatever your needs, we've got a vehicle to suit.
- Not to mention continual improvements behind the scenes to ensure your products are picked, packaged and shipped in a timely and effective manner.



# Contents

|                               |                    |
|-------------------------------|--------------------|
| Terms and Conditions          | <a href="#">6</a>  |
| Delivery                      | <a href="#">7</a>  |
| The Euroclass System          | <a href="#">10</a> |
| Technical Tools and Resources | <a href="#">12</a> |

## THINK YOU KNOW NYROCK?

|                         |                    |
|-------------------------|--------------------|
| NyRock® Cavity Slab 032 | <a href="#">14</a> |
| NyRock® Frame Slab 032  | <a href="#">17</a> |
| NyRock® Rainscreen 032  | <a href="#">20</a> |

## BUILDING INSULATION

|                                    |                    |
|------------------------------------|--------------------|
| <b>CAVITY SOLUTIONS</b>            | <a href="#">14</a> |
| NyRock® Cavity Slab 032            | <a href="#">14</a> |
| RockClose® EN                      | <a href="#">15</a> |
| Full Fill Cavity Batts             | <a href="#">15</a> |
| <b>FRAME SOLUTIONS</b>             | <a href="#">16</a> |
| NyRock® Frame Slab 032             | <a href="#">17</a> |
| Timber Frame Slab                  | <a href="#">17</a> |
| Steel Frame Slab                   | <a href="#">17</a> |
| <b>CLADDING SOLUTIONS</b>          | <a href="#">18</a> |
| RainScreen Duo Slab®               | <a href="#">19</a> |
| NyRock® Rainscreen 032             | <a href="#">20</a> |
| Cladding Roll                      | <a href="#">20</a> |
| SP FireStop OSCB 25                | <a href="#">22</a> |
| SP FireStop OSCB 44                | <a href="#">23</a> |
| SP FireStop EN                     | <a href="#">23</a> |
| <b>FLAT ROOF SOLUTIONS</b>         | <a href="#">25</a> |
| HardRock® UB34                     | <a href="#">26</a> |
| HardRock® Multi-Fix (DD)           | <a href="#">26</a> |
| HardRock® Underlay Slab            | <a href="#">27</a> |
| HardRock® Multi-Fix Recovery Board | <a href="#">27</a> |
| HardRock® Multi-Fix Angle Fillet   | <a href="#">27</a> |
| Acoustic Infill                    | <a href="#">28</a> |
| <b>FLOOR SOLUTIONS</b>             | <a href="#">30</a> |
| Acoustic RockFloor®                | <a href="#">31</a> |
| Thermal RockFloor®                 | <a href="#">31</a> |
| <b>ROLL PRODUCTS</b>               | <a href="#">32</a> |
| Twin Roll                          | <a href="#">33</a> |
| Roll                               | <a href="#">33</a> |
| Rollbatt                           | <a href="#">33</a> |
| <b>SLAB PRODUCTS</b>               | <a href="#">34</a> |
| Flexi®                             | <a href="#">35</a> |
| RW Slab Range RWA45                | <a href="#">35</a> |
| RW Slab Range RW3, RW4, RW5        | <a href="#">36</a> |

## TECHNICAL INSULATION

|  |                       |
|--|-----------------------|
| <b>STRUCTURAL AND CAVITY FIRE PROTECTION SOLUTIONS</b> | <a href="#">38</a>    |
| BeamClad®  | <a href="#">39</a>    |
| FirePro® Glue  | <a href="#">39</a>    |
| Fire Barrier EN  | <a href="#">40</a>    |
| SP FireStop EN   | <a href="#">40</a>    |
| SP FireStop Fixing Brackets                            | <a href="#">41</a>    |
| Dovetail Infill  | <a href="#">41</a>    |
| Linear Firestop  | <a href="#">42</a>    |
| Trapezoidal Firestop                                   | <a href="#">43</a>    |
| SCB (Sleeved Cavity Barrier)                           | <a href="#">44</a>    |
| Soffit Slab  | <a href="#">46</a>    |
| High Impact Soffit Slab                                | <a href="#">46</a>    |
| <b>FIRE STOPPING SOLUTIONS</b>                         | <a href="#">47</a>    |
| FirePro® Ablative Coated Batt                          | <a href="#">48</a>    |
| FirePro® Ablative Liquid                               | <a href="#">48</a>    |
| FirePro® Acoustic Intumescent Sealant                  | <a href="#">48</a>    |
| FirePro® Silicone X                                    | <a href="#">50</a>    |
| FirePro® FireStop Compound                             | <a href="#">50</a>    |
| FirePro® High Strength FireStop Compound               | <a href="#">50</a>    |
| FirePro® High Expansion Intumescent Sealant            | <a href="#">51</a>    |
| FirePro® Intumescent Pipewrap Roll                     | <a href="#">51</a>    |
| FirePro® SpeedSeal                                     | <a href="#">51</a>    |
| FirePro® Insulated Fire Sleeve                         | <a href="#">52</a>    |
| FirePro® Insulated Duct Sleeves                        | <a href="#">52</a>    |
| FirePro® Intumescent Pillow CE                         | <a href="#">53</a>    |
| FirePro® Intumescent Putty Pads                        | <a href="#">53</a>    |
| FirePro® Intumescent Pipe Wrap CE                      | <a href="#">54</a>    |
| FirePro® Pipe Collar CE                                | <a href="#">55</a>    |
| FirePro® SoftSeal System                               | <a href="#">56</a>    |
| <b>HVAC PRODUCTS</b>                                   | <a href="#">58</a>    |
| DuctSlab and DuctWrap                                  | <a href="#">59</a>    |
| DuoDuct External DuctSlab                              | <a href="#">59</a>    |
| DuctRock® Slab   | <a href="#">60</a>    |
| RockLap H&V Pipe Sections                              | <a href="#">62-63</a> |
| RockLap H&V Pipe Supports                              | <a href="#">64-65</a> |
| Techwrap2  | <a href="#">66</a>    |
| Fire Duct Slab   | <a href="#">66</a>    |

# Terms and Conditions

At ROCKWOOL, we have been manufacturing and stocking products locally for over 40 years. Our aim at all times is to give you the best possible customer experience.

To help offer you the very best service, we hold stocks in our newly expanded Logistics Centre in Bridgend of the most popular products. Everything contained in this price list is a Stocked item unless it has been designated as Made to Order.

## In Stock

Delivery times for In Stock items will be communicated within the order confirmation provided.

If your order is made up of a mixture of In Stock and Made to Order products, the order will be delivered in line with the longest lead time.

The minimum order quantity will consist of one pallet of a single product thickness, unless otherwise stated.

## Made to Order

Identified by a • symbol.

We know that occasionally you need something that's a little out of the ordinary, so we've also listed a selection of Made to Order products - these are labelled within the product tables.

Delivery times for Made to Order items will be communicated within the order confirmation provided.

If your order is made up of a mixture of In Stock and Made to Order products, the order will be delivered in line with the longest lead time.

Orders for Made to Order products cannot be accepted for less than the minimum order quantity displayed. The full order quantity must be taken as part of a single order which may be taken over multiple deliveries over a one month period.

Once ordered, Made to Order products cannot be cancelled and the full costs will be applied.

Whilst every effort has been made to ensure the accuracy of this price list and its contents, ROCKWOOL reserves the right to alter in the event of any errors or omissions. All prices listed are exclusive of VAT. E&OE.

For our full Terms and Conditions please visit [www.rockwool.com/uk/tandcs](http://www.rockwool.com/uk/tandcs)

## Non-Standard Products

Bespoke product and products not listed within this price list are defined as "Non-Standard Products."

Due to the nature of Non-Standard Products, prices and minimum order quantities will only be confirmed on request (within 5 working days). Lead times will be communicated in the same way as Made to Order items.

Orders for Non-Standard Products cannot be accepted for less than the confirmed minimum order quantity. The full order must be taken as part of a single order which may be taken over multiple deliveries within a period of one month.

## Fabrication Plant

Products manufactured in our fabrication plants are subject to different delivery service. Please see product listing for more information.

Lead times for fabricated products can vary and will be confirmed on receipt of order.

## Re-stocking/Returns

In exceptional circumstances and at our discretion some Stocked products may be returned. You will be responsible for the cost of collection of any agreed returns, and a re-stocking fee of a minimum of 25% of the list price will apply. A credit note will only be supplied if the product returned is in a saleable condition.

Made to Order and Non-Standard products cannot be returned.

## Customer Support - Aftercare

For POD's, invoice queries, delivery ETA's and complaints please contact:

**E-mail:** [DL-Aftercare-Team-GB@rockwool.com](mailto:DL-Aftercare-Team-GB@rockwool.com)

**Telephone:** 01656 868 400 (option 2)

### Opening Times:

Monday: 6.30am-5pm

Tuesday: 6.30am-5pm

Wednesday: 6.30am-5pm

Thursday: 6.30am-5pm

Friday: 6.30am-4pm

For complaints related to product quality, please include as much information as possible to help us investigate - material batch number from product label, quantity of material under issue, PO number and images of the issue under concern.



# Delivery

Whether delivering to yard or direct to site, ROCKWOOL has a variety of delivery option designed to meet your needs.



**Delivery Charges:** All full load deliveries are made free of charge (UK mainland only). Deliveries of less than one full load will incur charges as outlined below.

| Pallet Size: |      | 2400 x 1200mm<br>1200 x 1200mm |     | 2000 x 1200mm<br>2000 x 1000mm |     | 1200 x 880mm    |     | 1300 x 1200mm   |     | 1200 x 1200mm   |     | 1200 x 1000mm   |     |
|--------------|------|--------------------------------|-----|--------------------------------|-----|-----------------|-----|-----------------|-----|-----------------|-----|-----------------|-----|
| Load         | Cost | Pallet Load: 22                |     | Pallet Load: 26                |     | Pallet Load: 28 |     | Pallet Load: 40 |     | Pallet Load: 44 |     | Pallet Load: 52 |     |
|              |      | Min                            | Max | Min                            | Max | Min             | Max | Min             | Max | Min             | Max | Min             | Max |
| Full load    | €0   | 22                             | 22  | 26                             | 26  | 28              | 28  | 40              | 40  | 44              | 44  | 52              | 52  |
| 60-99%       | €195 | 13                             | 21  | 16                             | 25  | 17              | 27  | 24              | 39  | 26              | 43  | 31              | 51  |
| 50-59%       | €235 | 11                             | 12  | 13                             | 15  | 14              | 16  | 20              | 23  | 22              | 25  | 26              | 30  |
| 25-49%       | €325 | 6                              | 10  | 7                              | 12  | 7               | 13  | 10              | 19  | 11              | 21  | 13              | 25  |
| 0-24%        | POA  | 1                              | 5   | 1                              | 6   | 1               | 6   | 1               | 9   | 1               | 10  | 1               | 12  |

Need help planning your delivery load? Why not use our online load calculator? [www.rockwool.com/uk/loadcalc](http://www.rockwool.com/uk/loadcalc)

## Half Loads

Subject to availability and to the costs shown in the table above, half loads or more qualify for a timed delivery within a two hour window.

Loads which are less than half full are scheduled over a five working days period. You can secure a timed delivery within a two hour window for an additional charge of €330.

## Collections

Collections in a suitable vehicle can be arranged from ROCKWOOL in Pencoed, Bridgend between 7am and 12 noon Monday to Friday.

The ROCKWOOL Customer Support Centre will provide information on this service as required.

**Please Note:** all other terms and conditions remain the same.

## Delivery Vehicles

Our standard delivery vehicle is a 16.5m articulated HGV, weighing up to 44T, which may not be suitable for all sites. We aim to offer you the most sustainable, practical and cost effective delivery service possible, so we have also provided alternative delivery vehicle options for you to select from. If your delivery requires any of the options listed below please contact our Customer Support Team.

| Standard Delivery                       |  | Alternative Delivery Options - charges listed are in addition to table above    |   |
|---|--|---|---|
| 16.5m<br>Articulated HGV<br>(44 Tonnes) |  | <b>Flat Bed</b><br>+<br><b>€250</b><br>A crane will be required for offloading. | <b>Restricted Site Access</b><br>If your delivery destination has restricted site access, please contact our Customer Support Team. |
|   |  |   | <b>Rigid - POA</b>  |





# Delivery

## Amending Orders

For stocked items, orders can be amended without charge up to 4 working days before dispatch or additional charges will apply.

For made-to-order products, if manufacturing has commenced orders cannot be cancelled or amended, and the full costs of the products will be applied.

## Cancelled Deliveries

No customer order cancellations will be accepted after 3 working days following the date of issue of the order confirmation by ROCKWOOL.

### Stocked Items

- For products which have not been loaded, no charges will apply
- For products which have been loaded but have not left the site, a minimum handling charge of €110 will apply
- For products which are in transit for delivery, handling and transport costs will apply and will be confirmed by ROCKWOOL Customer Support Centre at the time of cancellation.

### Made to Order Items

- For products which have not been manufactured, no charges will apply
- For products which have been manufactured, the full order value will be charged
- For products which have been manufactured and are in transit for delivery, the full order value plus handling and transport costs will apply.

## Postponed Deliveries

### Stocked Items

The storage charge will be €110 per trailer per day.

### Made to Order Items

Storage charges will apply for Made to Order product deliveries that are postponed after the product has been manufactured. The storage charge will be €110 per trailer per day.

## Postponed Flat Bed Deliveries

Deliveries requested on flat bed trailers which are postponed within 48 hours of the agreed delivery date will be subject to postponement charges. Storage charges will apply.

## Refused Deliveries

Deliveries which are refused for any reason (e.g. windage, weather conditions etc) will incur costs which will include the delivery and return charges and ROCKWOOL handling fees.

## Redirected Deliveries

Deliveries that are redirected from the agreed delivery destination will incur charges. ROCKWOOL Customer Support Centre will confirm these costs at the time of request.

## Split Deliveries

We offer limited split deliveries on request where possible.

- Up to 20 miles between deliveries, from €80
- Other distances POA.

## Delayed Off-Loading

Waiting time charges at €80 per hour pro-rata will apply if the delivery vehicle is not off-loaded within two hours of the requested delivery time.



### Please Note:

Where you see this symbol different delivery details apply. Please see associated text for information.

# Clarín College, Athenry



**Client:**  
Department of Education & Skills,  
Government of Ireland

**Architect:**  
Healy Partners Architects

**Main contractor:**  
JJ Rhatigans

**Roofing contractor:**  
Priority Roofing

**Product:**  
ROCKWOOL HARDROCK®  
Multi-Fix Dual Density (DD)



# Technical Support

## The Euroclass System

The Euroclass Reaction to Fire system classifies building products in accordance with BS EN 13501-1. Using a product's Euroclass rating as guidance is the only way to determine a product's full Reaction to Fire performance. Products classified A1 or A2-s1, d0 are considered non-combustible and those classified B - F are considered combustible.

**Products are classified from A1-F:**

| Euroclass                     | Combustibility                  |
|-------------------------------|---------------------------------|
| <b>A1</b><br><b>A2-s1, d0</b> | Non-combustible                 |
| <b>B</b>                      |                                 |
| <b>C</b>                      |                                 |
| <b>D</b>                      | Combustible:                    |
| <b>E</b>                      | Will burn and may char or flame |
| <b>F</b>                      |                                 |
| <b>NPD</b>                    |                                 |

### Important Points to Remember...

- To be sure of a product's Euroclass rating, simply check its Declaration of Performance (DoP).
- A1 and A2 classified products are tested in accordance with the non-combustibility test EN ISO 1182\* to identify that they will not, or significantly not contribute to fire.
- All ROCKWOOL DoPs are available online at [rockwool.com/dop](https://rockwool.com/dop)

*\*A2 products can be tested to either EN ISO 1182 or EN ISO 1716.*



# Your learning, your way



With ROCKWOOL Learning you can:



Expand your knowledge and take control of your learning pathway



Complete courses at your preferred time and location



Access courses designed for all construction stakeholders



**ROCKWOOL®**

**Register today**



[rockwool.com/uk/learning](https://rockwool.com/uk/learning)

# Technical Tools and Resources

To assist you in the best possible way, we offer a range of free tools ranging from online software for calculating energy and heat loss to a materials calculator and much more.

Whether you are still at the beginning of your project or need technical support throughout, we are here to help along the way.



## Fire Stopping Standard Details Guide

The ROCKWOOL Fire Stopping Standard Details Guide provides in-depth guidance on the performance parameters of our passive fire stopping product solutions according to tested installations and applications.

## BIM Solution Finder

ROCKWOOL is proud to provide the BIM Solution Finder that will allow you to have the confidence in downloading the most recent BIM objects and the most up to date data for your projects.



## Flat Roof Zoning Tool

The ROCKWOOL Zoning Tool has been developed to ensure the efficient use of insulation products across a flat roof. Simply draw the roof borders, then zone the roof into different areas depending on the application.

## Acoustic Calculator

The ROCKWOOL Acoustic Calculator has been developed to provide reliable acoustic predictions for multiple building applications.

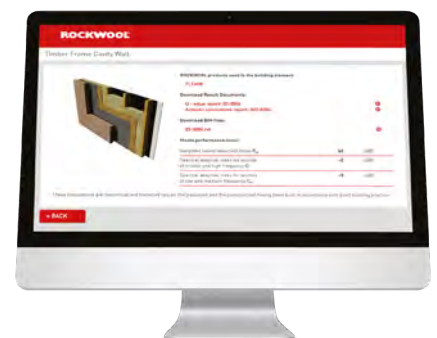

## U-Value Calculator

Our U-value calculation tool allows you to quickly and easily calculate the thermal performance of walls, floors and roofs, with around 2,500 predetermined calculations all completed under the BBA/TIMSA U-value competency scheme. It also helps you to specify the correct product and thickness to meet your customers' requirements.

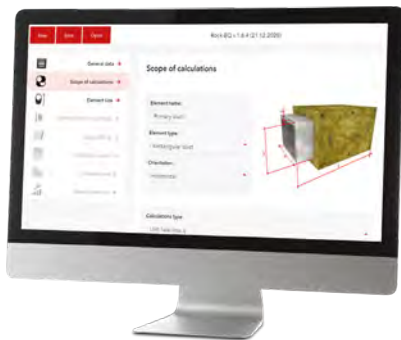

## Rock-EQ Calculator

Specifying the insulation for your HVAC systems is now easier thanks to the ROCKWOOL HVAC Calculation Tool.

# ROCKWOOL Resource Hubs...

Digital specification support for insulation applications.

Use the Resource Hubs to identify the right non-combustible stone wool insulation products for specific applications.

Explore the ROCKWOOL  
Resource Hubs now.

[www.rockwool.com/uk/resource-hubs](http://www.rockwool.com/uk/resource-hubs)



Mapped to key insulation application areas, the ROCKWOOL Resource Hubs provide access to technical tools, data, guidance and installation support all in one place:



**FirePro®**  
When specifying FirePro® products, the suite of resources provides guidance on all things passive fire protection.



**Ventilated Façade**  
Bringing together all relevant technical literature, the resource hub helps specifiers to navigate routes to compliance when using ventilated façades.



**Acoustic**  
Helping to better understand the role of building acoustics, specialist acoustics resources for creating safe and sound environments can be found here.



**Building Services and HVAC**  
A comprehensive suite of resources designed to save time and make it easier to deliver robust project specifications.



**Flat Roof**  
Support the design of flat roof insulation with specialist tools, guidance and technical data.



# Cavity Solutions

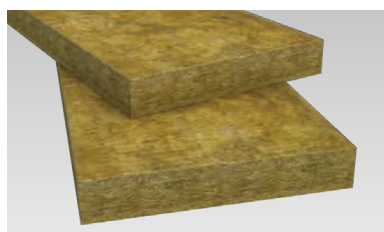

## NyRock® Cavity Slab 032

NyRock® Cavity Slab 032 is a full and partial fill stone wool slab designed for the thermal insulation of masonry cavity walls.

Suitable for use in new builds, renovations or extensions, the lightweight slabs are easy to handle and simple to install providing an accurate fit against the blockwork.

Lambda 0.032 W/mK

Pallet Size 1200 x 1200mm  
\*Pallet Size 1200 x 1000mm for 85mm only

### For Partial Fill Applications

| Product Code | Thickness (mm) | Width (mm) | Length (mm) | Pieces/ Pack | Area/ Pack (m²) | Packs/ Pallet | Area/pallet (m²) | Made to Order | MOQ (Pallet) | List Price/m² |
|--------------|----------------|------------|-------------|--------------|-----------------|---------------|------------------|---------------|--------------|---------------|
| 352334       | 50             | 455        | 1200        | 8            | 4.37            | 15            | 65.52            |               | 1            | €19.85        |
| 348004       | 75             | 455        | 1200        | 4            | 2.18            | 20            | 43.68            | •             | 22           | €29.77        |
| 352342*      | 85             | 455        | 1200        | 4            | 2.18            | 15            | 32.76            | •             | 26           | €33.74        |

### For Full Fill and Partial Fill Applications

|        |     |     |      |   |      |    |       |  |   |        |
|--------|-----|-----|------|---|------|----|-------|--|---|--------|
| 326646 | 100 | 455 | 1200 | 4 | 2.18 | 15 | 32.76 |  | 1 | €34.52 |
| 326652 | 125 | 455 | 1200 | 3 | 1.64 | 15 | 24.57 |  | 1 | €43.14 |
| 326657 | 150 | 455 | 1200 | 2 | 1.09 | 20 | 21.84 |  | 1 | €51.77 |
| 330079 | 160 | 455 | 1200 | 2 | 1.09 | 20 | 21.84 |  | 1 | €57.98 |
| 326660 | 200 | 455 | 1200 | 2 | 1.09 | 15 | 16.38 |  | 1 | €69.01 |

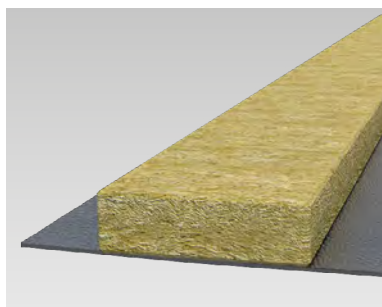

## RockClose EN

RockClose EN is an insulated cavity closer designed to minimise thermal bridging around windows and doors and also acts to inhibit the passage of smoke and fire within masonry, timber and steel frame constructions.

DPC length: 1300mm. DPC width: 180mm. Pallet Size 1200mm x 1200mm

| Product Code | Suitable for maximum cavity width (mm) | RockClose EN Dimensions (mm) |       |        | Linear m/ Pallet | Made to Order | MOQ (Linear m) | List Price/ Linear m |
|--------------|--|------------------------------|-------|--------|------------------|---------------|----------------|----------------------|
|              |  | Thickness                    | Width | Length |                  |               |                |                      |
| 356947       | 20                                     | 30                           | 100   | 1200   | 720              | •             | 200            | €52.15               |
| 356950       | 30                                     | 40                           | 100   | 1200   | 528              | •             | 200            | €53.31               |
| 356951       | 40                                     | 50                           | 100   | 1200   | 432              | •             | 200            | €53.98               |
| 356953       | 50                                     | 60                           | 100   | 1200   | 336              | •             | 200            | €57.48               |



RockClose® orders cannot be used to contribute towards mixed loads.  
The lead times for these products can vary and will be confirmed on receipt of order.  
Additional carriage charges may be applied

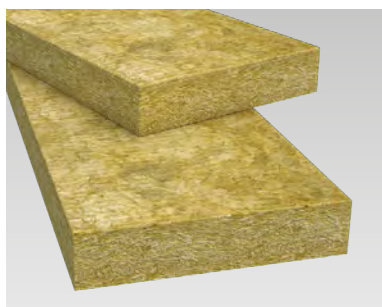

## Full Fill Cavity Batt

Full Fill Cavity Batt is non-combustible and contains water repellent additives which prevent moisture transmission between the outer and inner leaf.

Lambda 0.037 W/mK

Pallet Size 1200 x 1200mm

| Product Code | Thickness (mm) | Width (mm) | Length (mm) | Pieces/ Pack | Area/ Pack (m²) | Packs/ Pallet | Area/ Pallet (m²) | Made to Order | MOQ (Pallet) | List Price/m² |
|--------------|----------------|------------|-------------|--------------|-----------------|---------------|-------------------|---------------|--------------|---------------|
| 122878       | 50             | 455        | 1200        | 12           | 6.55            | 15            | 98.28             |               |              | €10.49        |
| 122880       | 75             | 455        | 1200        | 9            | 4.91            | 15            | 73.71             |               |              | €15.73        |
| 122881       | 80             | 455        | 1200        | 8            | 4.37            | 15            | 65.52             |               |              | €16.77        |
| 122883       | 100            | 455        | 1200        | 6            | 3.28            | 25            | 81.90             |               |              | €20.97        |
| 122888       | 150            | 455        | 1200        | 4            | 2.18            | 25            | 54.60             | •             | 22           | €31.41        |

# Frame Solutions

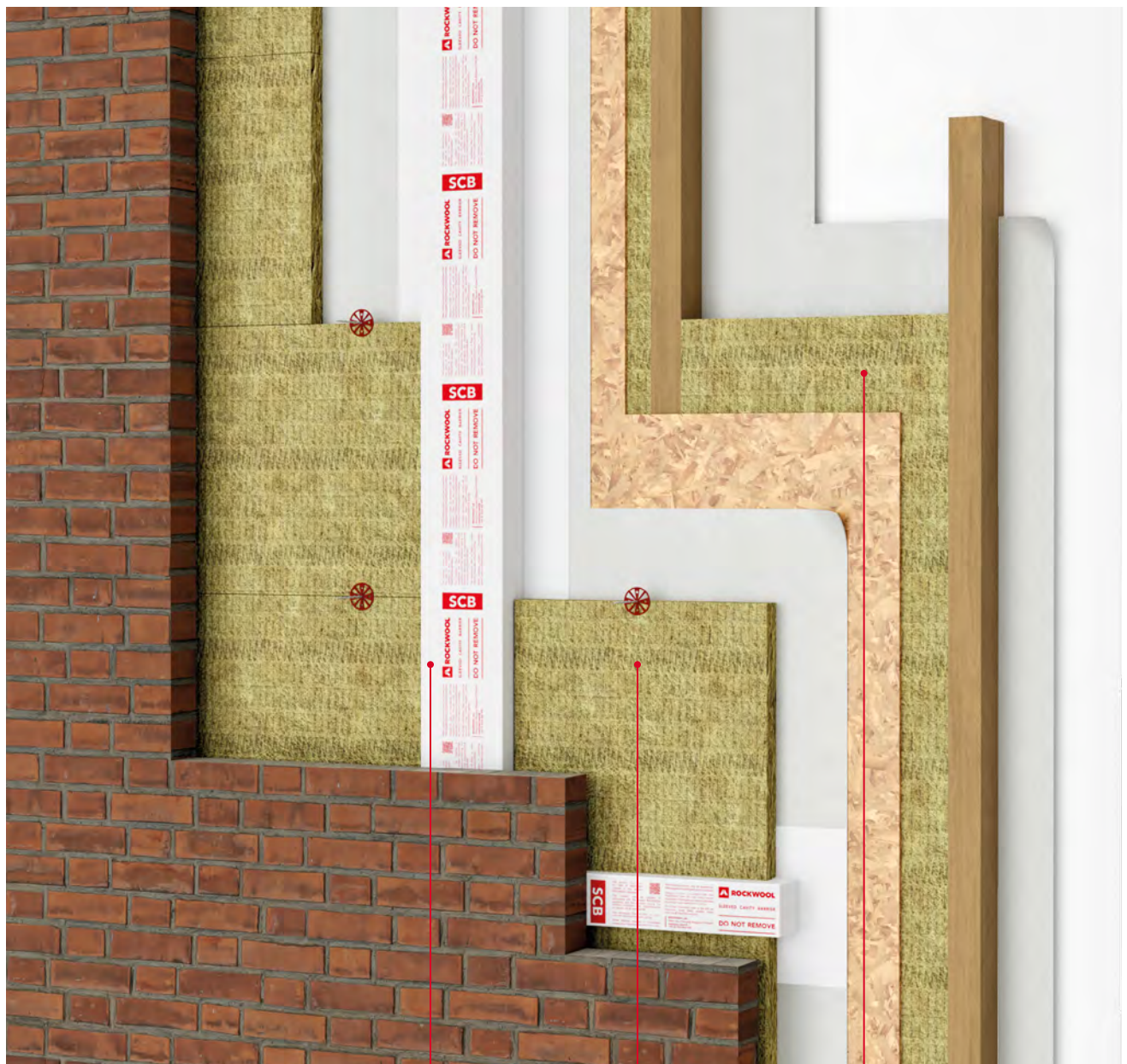

SCB (Sleeved  
Cavity Barrier)

NyRock®  
Rainscreen 032

NyRock®  
Frame 032

ROCKWOOL Frame Slabs are manufactured using a unique highspeed spinning process to produce stone wool insulation that is both light weight, for ease of installation, as well as low lambda, to help meet more demanding thermal performance requirements.

The slabs also provide acoustic protection and are Euroclass A1 non-combustible. Available in a variety of widths and thicknesses to suit the typical stud apertures of timber and steel frame constructions.



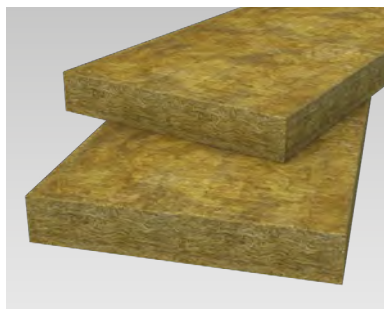

## NyRock® Frame Slab 032

NyRock® Frame Slab 032 is a semi-rigid stone wool insulation slab designed specifically for use between the studwork of external timber or light gauge steel frame walls.

Manufacturing using NyRock® technology, the slabs deliver insulation with optimised density and performance; offering a low thermal conductivity designed to meet and exceed thermal building regulations.

Lambda 0.032 W/mK

Pallet Size 1200 x 1200mm

| Product Code | Thickness (mm) | Width (mm) | Length (mm) | Pieces/ Pack | Area/ Pack (m²) | Packs/ Pallet | Area/ Pallet (m²) | Made to Order | MOQ (Pallet) | List Price/m² |
|--------------|----------------|------------|-------------|--------------|-----------------|---------------|-------------------|---------------|--------------|---------------|
| 326566       | 90             | 570        | 1200        | 4            | 2.74            | 12            | 32.83             | •             | 22           | €25.81        |
| 326599       | 140            | 570        | 1200        | 3            | 2.05            | 12            | 24.62             |               |              | €39.22        |
| 323861       | 100            | 600        | 1200        | 3            | 2.16            | 16            | 34.56             |               |              | €26.66        |
| 326570       | 120            | 600        | 1200        | 2            | 1.44            | 20            | 28.80             | •             | 22           | €31.93        |
| 326600       | 150            | 600        | 1200        | 2            | 1.44            | 16            | 23.04             |               |              | €39.98        |

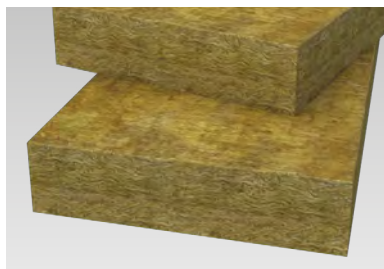

## Timber Frame Slab

With an increased focus on compliance with thermal, fire and acoustic performance for external walls, ROCKWOOL Timber Frame Slab has been engineered with an optimal density offering a low thermal conductivity, exceptional resistance to fire and outstanding sound absorption. The non-combustible stone wool insulation has dimensions specifically designed to enable quick and easy installation into timber frames.

Lambda 0.034 W/mK

Pallet Size 1200 x 1200mm

| Product Code | Thickness (mm) | Width (mm) | Length (mm) | Pieces/ Pack | Area/ Pack (m²) | Packs/ Pallet | Area/ Pallet (m²) | Made to Order | MOQ (Pallet) | List Price/m² |
|--------------|----------------|------------|-------------|--------------|-----------------|---------------|-------------------|---------------|--------------|---------------|
| 278730       | 90             | 570        | 1200        | 6            | 4.1             | 12            | 49.25             | •             | 22           | €19.83        |
| 278728       | 140            | 570        | 1200        | 4            | 2.74            | 12            | 32.83             |               |              | €30.17        |
| 282203       | 140            | 400        | 1200        | 4            | 1.92            | 18            | 34.56             | •             | 22           | €30.17        |

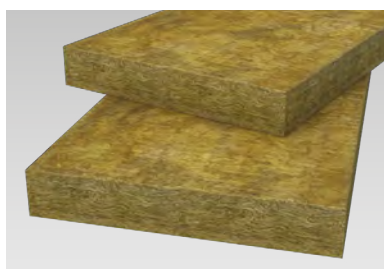

## Steel Frame Slab

Designed for fast, high quality external wall installations, ROCKWOOL Steel Frame Slab can help to meet or exceed the requirements (thermal) of Part L of the Building Regulations, by delivering a low thermal conductivity of 0.034 W/mK. The slabs are lightweight, easy to handle and are supplied in 600mm widths. This ensures a tight friction fit into standard frames, with no gaps, saving on installation time and keeping waste to an absolute minimum.

Lambda 0.034 W/mK

Pallet Size 1200 x 1200mm

| Product Code | Thickness (mm) | Width (mm) | Length (mm) | Pieces/ Pack | Area/ Pack (m²) | Packs/ Pallet | Area/ Pallet (m²) | List Price/m² |
|--------------|----------------|------------|-------------|--------------|-----------------|---------------|-------------------|---------------|
| 278727       | 100            | 600        | 1200        | 6            | 4.32            | 12            | 51.84             | €20.52        |
| 278712       | 120            | 600        | 1200        | 5            | 3.60            | 12            | 43.20             | €24.58        |
| 278725       | 150            | 600        | 1200        | 4            | 2.88            | 12            | 34.56             | €30.72        |

# Cladding Solutions

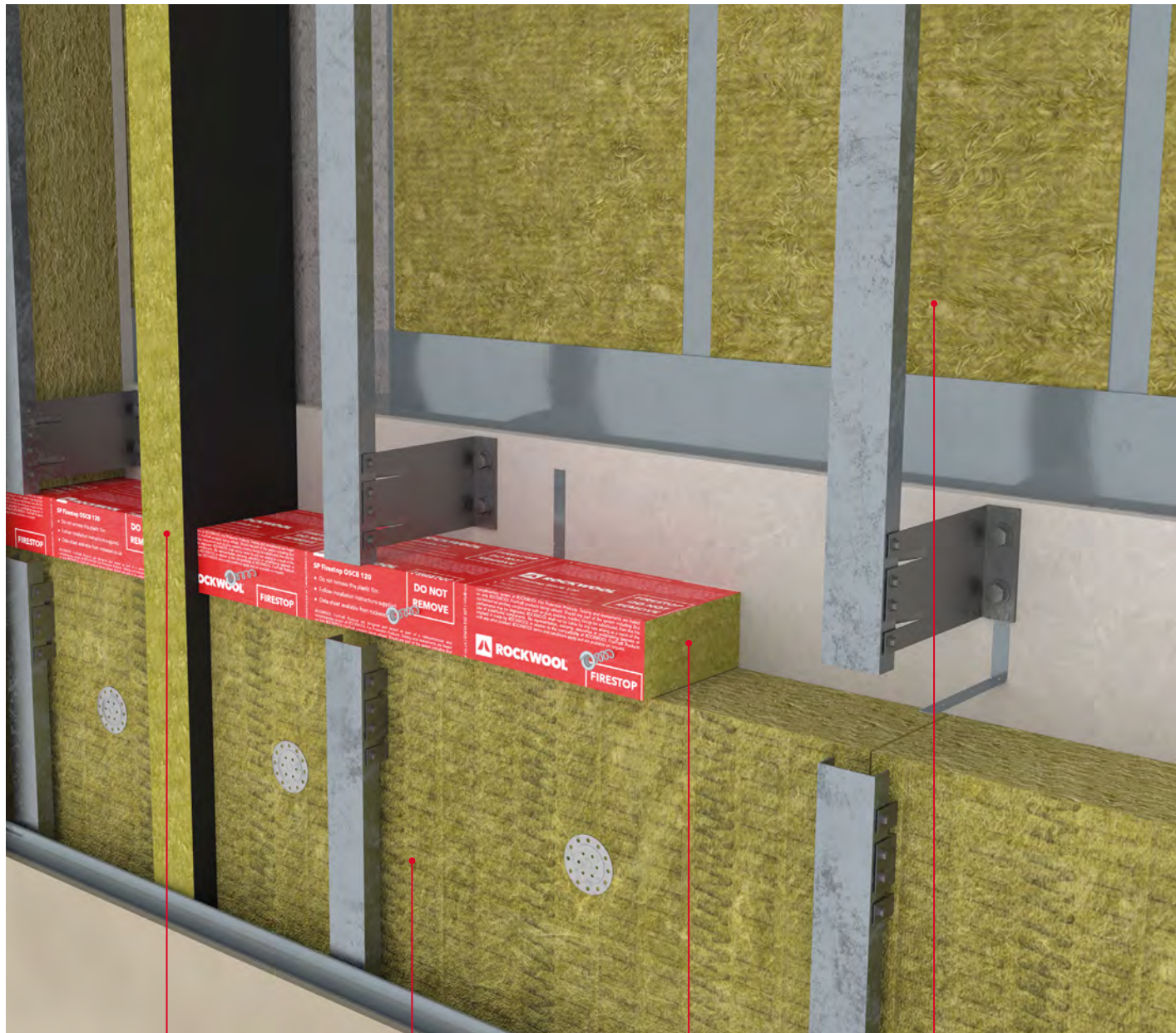

SP FireStop EN

Rainscreen Duo Slab or  
NyRock Rainscreen 032SP FireStop  
OSCBSteel Frame Slab  
or NyRock  
Frame 032

ROCKWOOL cladding solutions offer lightweight thermal, fire and acoustic cladding insulation suitable for external wall and roof applications.

These include ventilated façade systems and built-up metal wall and roof systems. The ROCKWOOL range of cladding insulation delivers excellent fire protection and soundproofing performance, and are available in a variety of thicknesses.

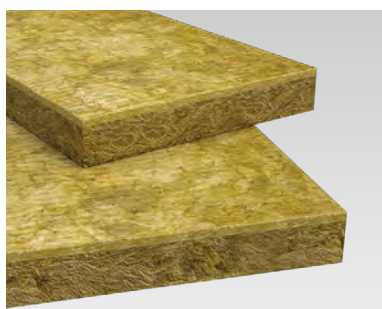

## RainScreen Duo Slab®

RainScreen Duo Slab® is a dual density insulation board comprising a robust outer surface and a resilient inner face which has been designed for use in conditions of severe climatic exposure. Because of its unique dual density construction RainScreen Duo Slab® requires fewer fixings, thus providing a cost effective solution in over cladding applications.

Lambda 0.035 W/mK, Lambda 0.034 W/mK\*

Pallet Size 1200 x 1200mm

|   | Product Code | Thickness (mm) | Width (mm) | Length (mm) | Pieces/ Pack | Area/ Pack (m²) | Packs/ Pallet | Area/ Pallet (m²) | Made to Order | MOQ (Pallet) | List Price/m² |
|---|--------------|----------------|------------|-------------|--------------|-----------------|---------------|-------------------|---------------|--------------|---------------|
|   | 221343*      | 50             | 600        | 1200        | 8            | 5.76            | 12            | 69.12             |               |              | €37.90        |
|   | 221347*      | 60             | 600        | 1200        | 6            | 4.32            | 12            | 51.84             |               |              | €45.22        |
|   | 221352*      | 75             | 600        | 1200        | 6            | 4.32            | 12            | 51.84             |               |              | €56.71        |
|   | 283606*      | 80             | 600        | 1200        | 4            | 2.88            | 16            | 46.08             |               |              | €65.96        |
|   | 221359       | 90             | 600        | 1200        | 4            | 2.88            | 12            | 34.56             |               |              | €72.27        |
|   | 221361       | 100            | 600        | 1200        | 4            | 2.88            | 12            | 34.56             |               |              | €75.23        |
|   | 225556       | 110            | 600        | 1200        | 4            | 2.88            | 12            | 34.56             |               |              | €80.33        |
|   | 300182       | 120            | 600        | 1200        | 4            | 2.88            | 12            | 34.56             |               |              | €85.71        |
|   | 300183       | 125            | 600        | 1200        | 4            | 2.88            | 12            | 34.56             |               |              | €89.33        |
|   | 251046       | 130            | 600        | 1200        | 3            | 2.16            | 12            | 25.92             | •             | 22           | €98.93        |
|   | 251257       | 140            | 600        | 1200        | 3            | 2.16            | 12            | 25.92             |               |              | €101.70       |
|   | 221334       | 150            | 600        | 1200        | 3            | 2.16            | 12            | 25.92             |               |              | €112.70       |
|   | 251989       | 160            | 600        | 1200        | 2            | 1.44            | 16            | 23.04             | •             | 22           | €120.24       |
|   | 248930       | 170            | 600        | 1200        | 2            | 1.44            | 16            | 23.04             | •             | 22           | €123.41       |
|   | 348416       | 180            | 600        | 1200        | 3            | 2.16            | 12            | 25.92             |               |              | €135.25       |
|   | 235884       | 190            | 600        | 1200        | 2            | 1.44            | 12            | 17.28             | •             | 22           | €144.29       |
|   | 247869       | 200            | 600        | 1200        | 2            | 1.44            | 12            | 17.28             |               |              | €149.54       |
|   | 235883       | 220            | 600        | 1200        | 2            | 1.44            | 12            | 17.28             | •             | 22           | €156.86       |
|   | 239219       | 225            | 600        | 1200        | 2            | 1.44            | 12            | 17.28             | •             | 22           | €159.49       |
| ◆ | 254360       | 180            | 600        | 1000        | 3            | 1.80            | 10            | 18                | •             | 22           | €162.52       |

KEY: ◆ ALU Faced

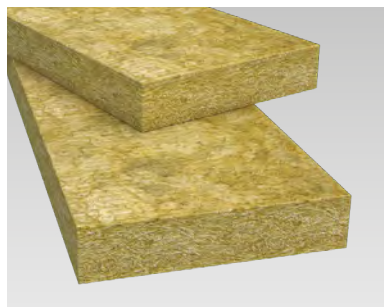

## NyRock® Rainscreen 032

NyRock® Rainscreen 032 is specifically developed for use within ventilated cladding systems, as well as sealed systems such as curtain walling.

The product can be easily fitted around brackets and other awkward details, and when tightly butted, adjacent slabs effectively 'knit' together to provide a continuous insulating layer, reducing heat losses that would otherwise be caused by gaps.

Lambda 0.032 W/mK

Pallet Size 2400 x 1200mm

| Product Code | Thickness (mm) | Width (mm) | Length (mm) | Pieces/ Pack | Area/ Pack (m <sup>2</sup> ) | Packs/ Pallet | Area/ Pallet (m <sup>2</sup> ) | Made to Order | MOQ (Pallet) | List Price/m <sup>2</sup> |
|--------------|----------------|------------|-------------|--------------|------------------------------|---------------|--------------------------------|---------------|--------------|---------------------------|
| 326324       | 50             | 600        | 1200        | 6            | 4.32                         | 16            | 69.12                          | •             | 22           | €45.68                    |
| 328258       | 60             | 600        | 1200        | 6            | 4.32                         | 12            | 51.84                          | •             | 22           | €54.51                    |
| 326354       | 70             | 600        | 1200        | 4            | 2.88                         | 16            | 46.08                          | •             | 22           | €63.59                    |
| 326361       | 75             | 600        | 1200        | 4            | 2.88                         | 16            | 46.08                          |               |              | €68.32                    |
| 326362       | 80             | 600        | 1200        | 4            | 2.88                         | 16            | 46.08                          |               |              | €79.48                    |
| 328260       | 85             | 600        | 1200        | 3            | 2.16                         | 20            | 43.20                          | •             | 22           | €84.45                    |
| 326364       | 90             | 600        | 1200        | 4            | 2.88                         | 12            | 34.56                          |               |              | €87.11                    |
| 326367       | 100            | 600        | 1200        | 3            | 2.16                         | 16            | 34.56                          |               |              | €90.65                    |
| 328261       | 110            | 600        | 1200        | 3            | 2.16                         | 12            | 25.92                          |               |              | €96.82                    |
| 326372       | 115            | 600        | 1200        | 3            | 2.16                         | 12            | 25.92                          | •             | 22           | €101.21                   |
| 326376       | 125            | 600        | 1200        | 3            | 2.16                         | 12            | 25.92                          |               |              | €107.65                   |
| 326381       | 135            | 600        | 1200        | 3            | 2.16                         | 12            | 25.92                          |               |              | €116.27                   |
| 326383       | 150            | 600        | 1200        | 2            | 1.44                         | 16            | 23.04                          |               |              | €135.82                   |
| 326385       | 165            | 600        | 1200        | 2            | 1.44                         | 12            | 17.28                          | •             | 22           | €149.42                   |
| 326395       | 180            | 600        | 1200        | 2            | 1.44                         | 12            | 17.28                          | •             | 22           | €162.99                   |
| 326396       | 200            | 600        | 1200        | 2            | 1.44                         | 12            | 17.28                          |               |              | €180.22                   |



## Cladding Roll

Cladding Roll is a lightweight, flexible mat which delivers a combination of thermal, fire and acoustic performance. Suitable for use within built up metal roof and wall applications ROCKWOOL® Cladding Roll is available in a variety of thicknesses and can be produced with an aluminium facing for increased tensile strength in vertical wall applications.

Lambda 0.040 W/mK

Pallet Size 1200 x 1200mm

| Product Code | Thickness (mm) | Width (mm) | Length (mm) | Pieces/ Pack | Area/ Pack (m <sup>2</sup> ) | Packs/ Pallet | Area/ Pallet (m <sup>2</sup> ) | Made to Order | MOQ (Pallet) | List Price/m <sup>2</sup> |
|--------------|----------------|------------|-------------|--------------|------------------------------|---------------|--------------------------------|---------------|--------------|---------------------------|
| 122905       | 60             | 1200       | 3200        | 2            | 7.68                         | 18            | 138.24                         |               |              | €9.52                     |
| 122906       | 80             | 1200       | 5000        | 1            | 6.00                         | 18            | 108.00                         | •             | 22           | €12.68                    |
| 122907       | 100            | 1200       | 4800        | 1            | 5.76                         | 18            | 103.68                         |               |              | €15.84                    |
| 122908       | 120            | 1200       | 4000        | 1            | 4.80                         | 18            | 86.40                          | •             | 22           | €19.07                    |
| 122909       | 150            | 1200       | 3200        | 1            | 3.84                         | 18            | 69.12                          |               |              | €24.55                    |
| 255780*      | 150            | 1000       | 3200        | 1            | 3.20                         | 21            | 67.20                          | •             | 22           | €36.58                    |
| 122911       | 180            | 1200       | 2700        | 1            | 3.24                         | 18            | 58.32                          |               |              | €28.42                    |
| 122913       | 220            | 1200       | 2200        | 1            | 2.64                         | 18            | 47.52                          | •             | 22           | €34.75                    |

\*Foil Faced For vertical applications we would strongly advise the use of foil faced cladding roll.



# High rise residential, made easier

Design and specify effective high rise structures with our sector guide, 'ROCKWOOL for High Rise Residential Projects'.

Built around the concept that modern high rise homes should be as safe as they are comfortable, the guide offers:



Application-specific advice for insulation



Relevant case studies



Acoustic, thermal and fire protection performance guidance



Building regulations advice for high rise residential projects



More information on key ROCKWOOL resources and CPDs

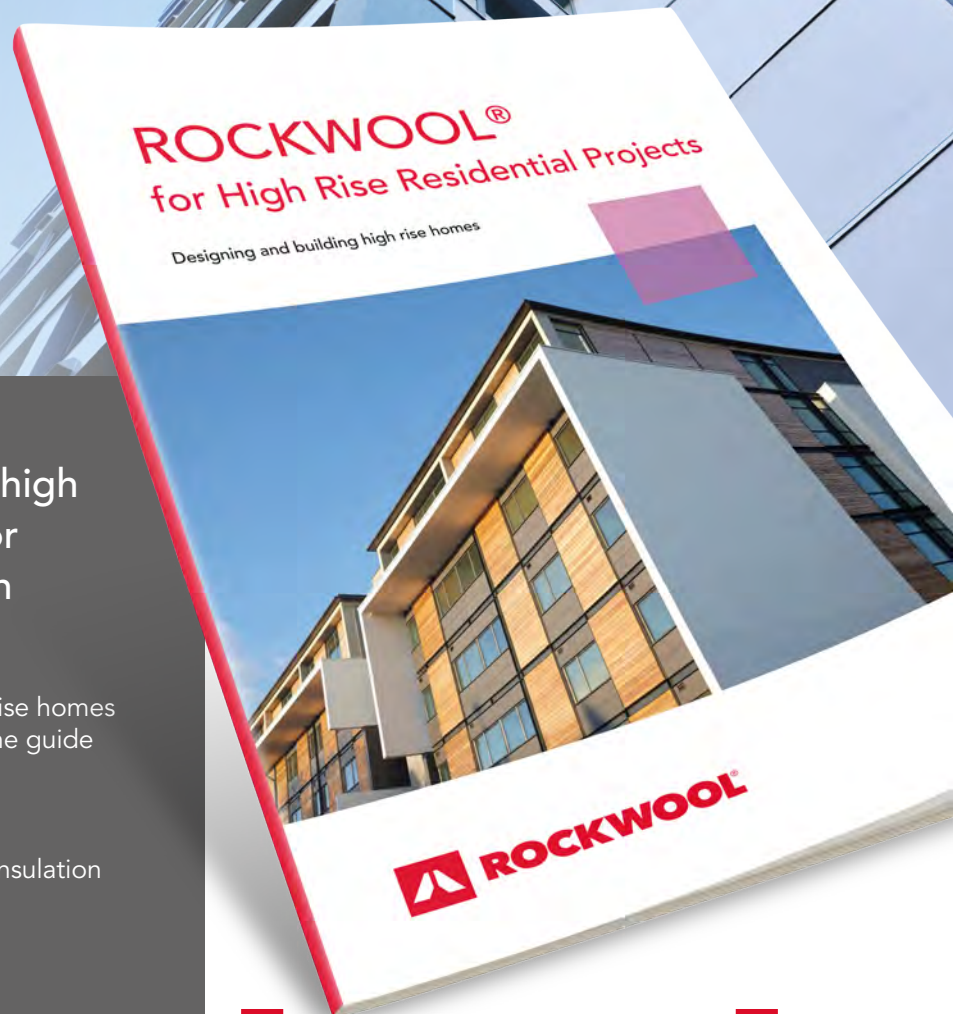

Download 'ROCKWOOL for High Rise Residential Projects':



[rockwool.com/uk/high-rise](https://rockwool.com/uk/high-rise)



X in f o y  
[rockwool.com/uk](https://rockwool.com/uk)



## SP FireStop OSCB 25

Specifically designed for use only in conjunction with either ROCKWOOL Rainscreen Duo Slab® or NyRock Rainscreen 032, SP FireStop OSCB 25\* forms an open-state cavity fire barrier within the building façade, allowing for an open cavity of up to 25mm for ventilation and drainage.

This product provides up to 120 minutes integrity and insulation.

*\* Product codes for SP FireStop OSCB 25 will be supplied on receipt of order.*

*Prices indicated are inclusive of stainless steel pigtail screws and galvanised steel fixing brackets. These items are supplied in a box located at the bottom of a clearly marked pallet. Stainless steel brackets are available at an extra cost of €3.24 per linear metre - please specify when ordering if these are required.*

*Please contact the ROCKWOOL Customer Support Team for further information.*

Length 1000mm. Depth 90mm

| Width Dimensions (mm) |                     | List Price |
|-----------------------|---------------------|------------|
| Product               | Max. Overall Cavity |            |
| 75                    | 100                 | €40.42     |
| 80                    | 105                 | €40.96     |
| 85                    | 110                 | €41.48     |
| 90                    | 115                 | €41.78     |
| 95                    | 120                 | €42.13     |
| 100                   | 125                 | €42.85     |
| 105                   | 130                 | €43.25     |
| 110                   | 135                 | €43.77     |
| 115                   | 140                 | €43.91     |
| 120                   | 145                 | €44.77     |
| 125                   | 150                 | €44.99     |
| 130                   | 155                 | €45.54     |
| 135                   | 160                 | €46.13     |
| 140                   | 165                 | €46.34     |
| 145                   | 170                 | €46.58     |
| 150                   | 175                 | €47.78     |
| 155                   | 180                 | €47.93     |
| 160                   | 185                 | €48.22     |
| 165                   | 190                 | €48.38     |
| 170                   | 195                 | €49.92     |
| 175                   | 200                 | €50.07     |
| 180                   | 205                 | €50.37     |
| 185                   | 210                 | €50.60     |
| 190                   | 215                 | €50.76     |
| 195                   | 220                 | €50.97     |
| 200                   | 225                 | €52.94     |
| 205                   | 230                 | €53.25     |
| 210                   | 235                 | €53.49     |
| 215                   | 240                 | €53.62     |
| 220                   | 245                 | €53.84     |
| 225                   | 250                 | €53.98     |
| 230                   | 255                 | €54.22     |
| 235                   | 260                 | €54.38     |
| 240                   | 265                 | €57.52     |
| 245                   | 270                 | €57.66     |
| 250                   | 275                 | €57.87     |
| 255                   | 280                 | €58.04     |
| 260                   | 285                 | €58.28     |
| 265                   | 290                 | €58.41     |
| 270                   | 295                 | €58.63     |
| 275                   | 300                 | €58.86     |
| 280                   | 305                 | €59.01     |

| Width Dimensions (mm) |                     | List Price |
|-----------------------|---------------------|------------|
| Product               | Max. Overall Cavity |            |
| 285                   | 310                 | €59.23     |
| 290                   | 315                 | €59.68     |
| 295                   | 320                 | €59.84     |
| 300                   | 325                 | €64.57     |
| 305                   | 330                 | €64.74     |
| 310                   | 335                 | €64.96     |
| 315                   | 340                 | €65.10     |
| 320                   | 345                 | €65.33     |
| 325                   | 350                 | €65.55     |
| 330                   | 355                 | €65.69     |
| 335                   | 360                 | €65.93     |
| 340                   | 365                 | €66.08     |
| 345                   | 370                 | €66.30     |
| 350                   | 375                 | €66.46     |
| 355                   | 380                 | €66.68     |
| 360                   | 385                 | €67.28     |
| 365                   | 390                 | €67.49     |
| 370                   | 395                 | €67.73     |
| 375                   | 400                 | €67.88     |
| 380                   | 405                 | €68.11     |
| 385                   | 410                 | €68.25     |
| 390                   | 415                 | €68.48     |
| 395                   | 420                 | €68.62     |
| 400                   | 425*                | €77.84     |
| 405                   | 430                 | €78.08     |
| 415                   | 440                 | €78.45     |
| 425                   | 450                 | €78.85     |
| 435                   | 460                 | €79.19     |
| 445                   | 470                 | €79.64     |
| 455                   | 480                 | €80.04     |
| 465                   | 490                 | €80.41     |
| 475                   | 500                 | €80.77     |
| 485                   | 510                 | €82.07     |
| 495                   | 520                 | €82.41     |
| 505                   | 530                 | €82.79     |
| 515                   | 540                 | €83.19     |
| 525                   | 550                 | €83.54     |
| 535                   | 560                 | €84.00     |
| 545                   | 570                 | €84.37     |
| 555                   | 580                 | €84.77     |
| 565                   | 590                 | €85.12     |
| 575                   | 600                 | €85.51     |



OSCB orders cannot be used to contribute towards mixed loads. These products are delivered direct from our fabrication plant. Additional carriage charges may apply. The lead times for these products can vary and will be confirmed on receipt of order.

*\* For voids equal to 425mm and up to 600mm a minimum thickness of 300mm of Rainscreen Duo Slab/NyRock Rainscreen 032 is required both above and below the cavity barrier.*



## SP FireStop OSCB 44

Specifically designed for use only in conjunction with either ROCKWOOL Rainscreen Duo Slab® or NyRock Rainscreen 032, SP FireStop OSCB 44\* forms an open-state cavity fire barrier within the building façade, allowing for an open cavity of up to 44mm for ventilation and drainage.

This product provides up to 120 minutes integrity and insulation.

*\* Product codes for the OSCB 44 will be supplied on receipt of the order.*

*Prices indicated are inclusive of galvanised steel fixing brackets. OSCB 44 does not require pigtail screws. The brackets are supplied in a box located at the bottom of a clearly marked pallet. Stainless steel brackets are available at an extra cost of €3.24 per linear metre - please specify when ordering if these are required. Please contact the ROCKWOOL Customer Support Team for further information.*

Length 1000mm. Depth 90mm

| Width Dimensions (mm) |                     | List Price |
|-----------------------|---------------------|------------|
| Product               | Max. Overall Cavity |            |
| 56                    | 100                 | €65.67     |
| 61                    | 105                 | €66.08     |
| 66                    | 110                 | €66.48     |
| 71                    | 115                 | €66.93     |
| 76                    | 120                 | €67.32     |
| 81                    | 125                 | €67.73     |
| 86                    | 130                 | €68.17     |
| 91                    | 135                 | €68.39     |
| 96                    | 140                 | €68.81     |
| 101                   | 145                 | €69.37     |
| 106                   | 150                 | €69.55     |
| 111                   | 155                 | €70.14     |
| 116                   | 160                 | €70.35     |
| 121                   | 165                 | €71.00     |
| 126                   | 170                 | €71.21     |
| 131                   | 175                 | €71.39     |
| 136                   | 180                 | €72.18     |
| 141                   | 185                 | €72.37     |
| 146                   | 190                 | €72.58     |
| 151                   | 195                 | €73.58     |
| 156                   | 200                 | €73.70     |
| 161                   | 205                 | €73.97     |
| 166                   | 210                 | €74.16     |
| 171                   | 215                 | €74.31     |
| 176                   | 220                 | €75.57     |
| 181                   | 225                 | €75.83     |
| 186                   | 230                 | €76.02     |
| 191                   | 235                 | €76.17     |
| 196                   | 240                 | €76.38     |
| 201                   | 245                 | €78.00     |
| 206                   | 250                 | €78.29     |
| 211                   | 255                 | €78.48     |
| 216                   | 260                 | €78.63     |

| Width Dimensions (mm) |                     | List Price |
|-----------------------|---------------------|------------|
| Product               | Max. Overall Cavity |            |
| 221                   | 265                 | €78.84     |
| 226                   | 270                 | €79.00     |
| 231                   | 275                 | €79.15     |
| 236                   | 280                 | €79.37     |
| 241                   | 285                 | €81.94     |
| 246                   | 290                 | €82.09     |
| 251                   | 295                 | €82.28     |
| 256                   | 300                 | €82.46     |
| 261                   | 305                 | €82.61     |
| 266                   | 310                 | €82.79     |
| 271                   | 315                 | €82.94     |
| 276                   | 320                 | €83.12     |
| 281                   | 325                 | €83.28     |
| 286                   | 330                 | €83.75     |
| 291                   | 335                 | €83.88     |
| 296                   | 340                 | €84.09     |
| 301                   | 345                 | €87.99     |
| 306                   | 350                 | €88.16     |
| 311                   | 355                 | €88.31     |
| 316                   | 360                 | €88.49     |
| 321                   | 365                 | €88.64     |
| 326                   | 370                 | €88.83     |
| 331                   | 375                 | €88.99     |
| 336                   | 380                 | €89.17     |
| 341                   | 385                 | €89.37     |
| 346                   | 390                 | €89.49     |
| 351                   | 395                 | €89.72     |
| 356                   | 400                 | €89.83     |
| 361                   | 405                 | €90.47     |
| 366                   | 410                 | €90.57     |
| 371                   | 415                 | €90.78     |
| 376                   | 420                 | €90.92     |
| 381                   | 425                 | €91.12     |

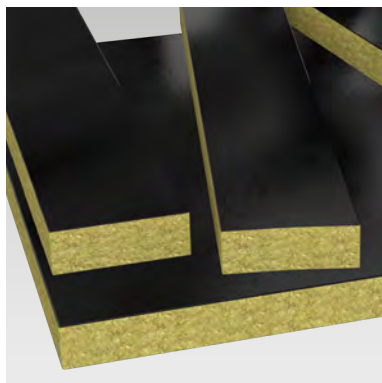

## SP FireStop EN

SP FireStop EN has been tested in accordance with BS EN 1366-4:2021 and is suitable for use as a linear cavity firestop in both vertical and horizontal orientations. SP FireStop EN has been tested with multiple substrate types including masonry/concrete, SFS and composite panels with a stone wool core.

SP FireStop EN has also been tested in accordance with BS EN 1364-4:2014, curtain walling - part configuration.

For pricing and further information please refer to page 40.



# ROCKWOOL SP FireStop EN

**A linear cavity fire stopping solution  
suitable for vertical and horizontal  
installation.**

- Tested for use with steel frame substrates, composite panels and masonry
- Up to 120 minutes integrity and insulation in cavities up to 600mm\*
- Tested to BS EN 1366-4:2021 and BS EN 1366-4:2014
- Suitable for 'installation from below'



\*Subject to the application

**Find out more:**



[rockwool.com/uk/  
sp-firestop-en](https://rockwool.com/uk/sp-firestop-en)



[rockwool.com/uk](https://rockwool.com/uk)

[< Back to Contents Page](#)

# Flat Roof Solutions

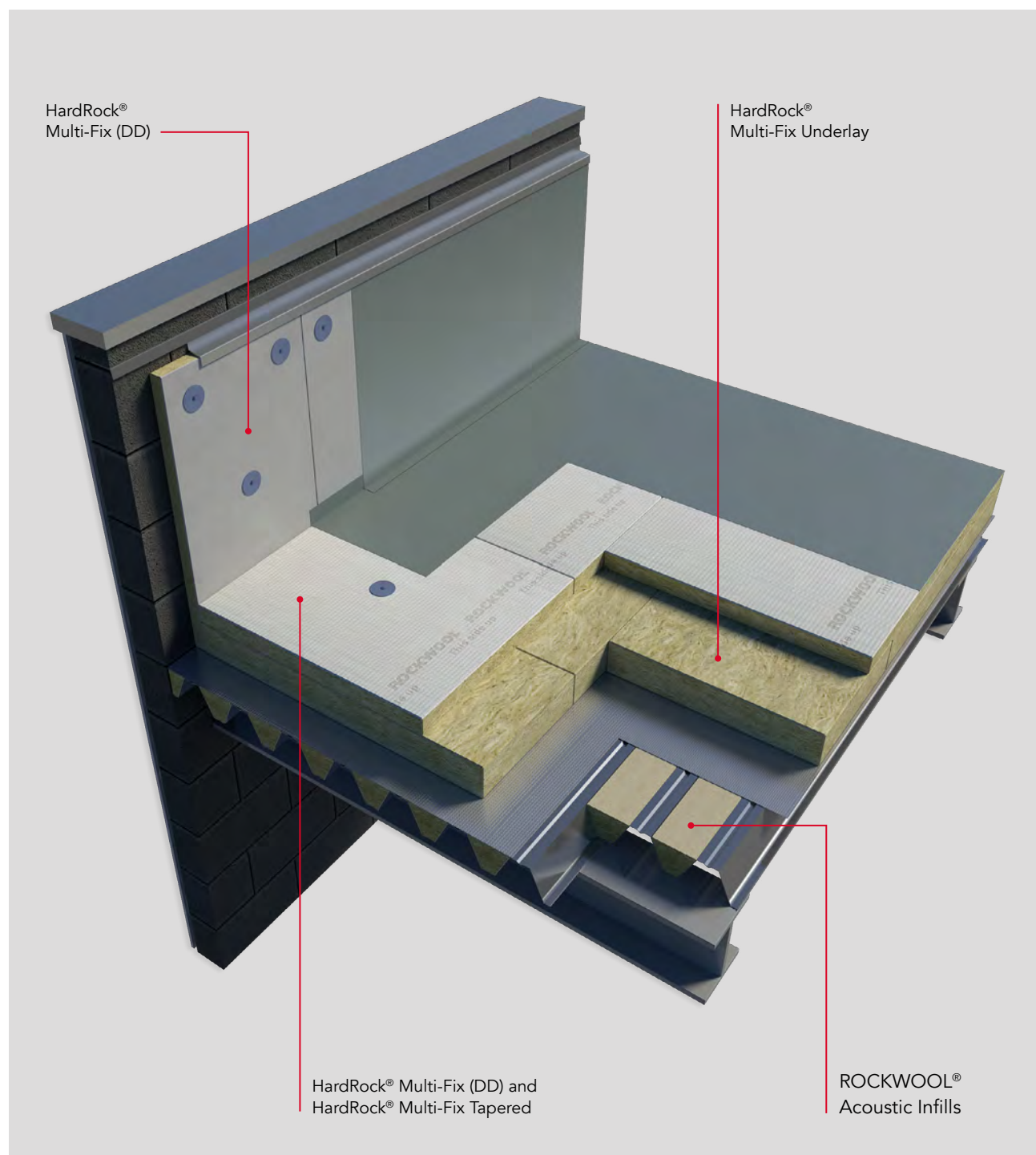

ROCKWOOL flat roof solutions have been designed to meet the demands of modern roof systems, providing durable solutions which simplify design.



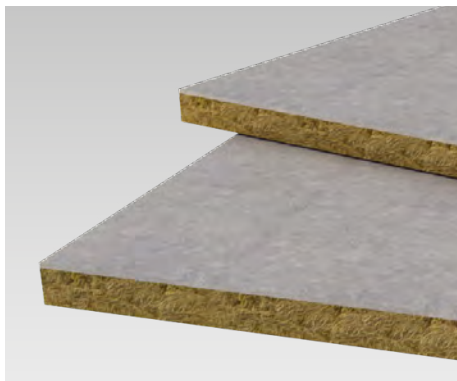

## HardRock® UB34

Consisting of non-combustible ROCKWOOL insulation faced with an exterior grade non-combustible 6mm fibre cement board, HardRock UB34 achieves a EUROCLASS fire classification of A2, s1-d0, offering a non-combustible solution for insulating upstands and parapet walls.

Lambda 0.034 W/mK

Pallet Size 2400 x 1200mm

| Product Code | Additional Information                | Thickness (mm) | Width (mm) | Length (mm) | Pieces/ Pallet | Area/ Pallet (m²) | Made to Order | MOQ (Pallet) | List Price/ Board |
|--------------|---------------------------------------|----------------|------------|-------------|----------------|-------------------|---------------|--------------|-------------------|
| 284556       | 6mm exterior grade fibre cement board | 56             | 600        | 1200        | 72             | 51.84             | •             | 1            | €123.46           |

When it comes to specifying high performing non-combustible insulation, the majority of focus has been on external walls - but overlooking the roof could introduce a weak link into the building envelope. According to government reports, between 2010 and 2018 there were 4,290 fires in England where the roof was deemed to have been “mainly responsible for the development of the fire”.<sup>\*</sup> We urge you to push the envelope and specify ROCKWOOL on your build as it is just as important to have non-combustible, thermally efficient insulation on the roof as it is on the façade.

**Lisa Stephens, Product Manager – Flat Roof & Façades**

<sup>\*</sup>Source: gov.uk - FIRE0603: Primary fires fatalities and non-fatal casualties by item first ignited.

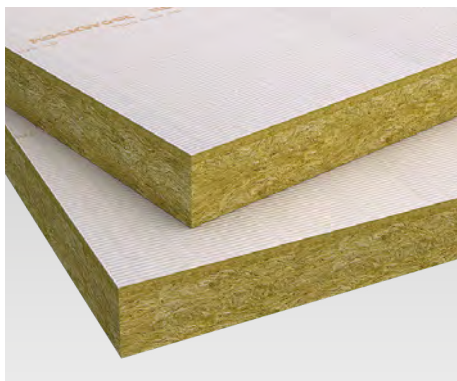

## HardRock® Multi-Fix (DD)

HardRock® Multi-Fix (DD) is a BBA-approved stone wool insulation board faced with a mineral-coated white fleece, compatible with a wide range of adhered and mechanically-fixed waterproofing systems - including bitumen, single-ply, EPDM and liquid membranes, as well as green roof systems.

HardRock® Multi-Fix (DD) can also be used above rafters for warm pitched roof applications.

Lambda 0.039 W/mK

Pallet Size 1200 x 1000mm

| Product Code | Thickness (mm) | Width (mm) | Length (mm) | Pieces/ Pallet | Area/ Pallet (m²) | MOQ (Pallet) | List Price/m² |
|--------------|----------------|------------|-------------|----------------|-------------------|--------------|---------------|
| 138230       | 60             | 1000       | 1200        | 20             | 24.00             | 1            | €41.93        |
| 133134       | 85             | 1000       | 1200        | 15             | 18.00             | 1            | €53.51        |
| 132664       | 105            | 1000       | 1200        | 12             | 14.40             | 1            | €63.94        |
| 138250       | 115            | 1000       | 1200        | 10             | 12.00             | 1            | €70.24        |
| 133090       | 150            | 1000       | 1200        | 8              | 9.60              | 1            | €87.72        |
| 136405       | 185            | 1000       | 1200        | 6              | 7.20              | 1            | €107.71       |



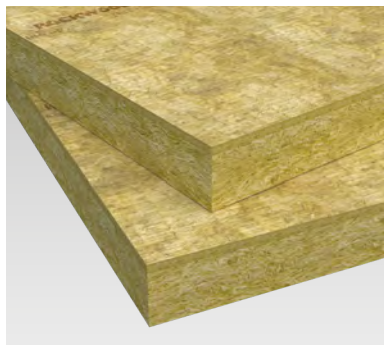

## HardRock® Multi-Fix (DD) Underlay Slab

Designed to be installed with HardRock® Multi-Fix DD, HardRock® Underlay forms a cost-effective base layer within multi-layer solutions. Manufactured from non-combustible stone wool, this robust product will contribute to the thermal, acoustic and fire performance of a flat roof system.

Lambda 0.039 W/mK

Pallet Size 1200 x 1000mm

| Product Code | Thickness (mm) | Width (mm) | Length (mm) | Pieces/ Pallet | Area/ Pallet (m²) | MOQ (Pallet) | List Price/m² |
|--------------|----------------|------------|-------------|----------------|-------------------|--------------|---------------|
| 155103       | 120            | 1000       | 1200        | 10             | 12.00             | 52           | €71.51        |
| 138251       | 150            | 1000       | 1200        | 8              | 9.60              | 1            | €72.11        |
| 216597       | 170            | 1000       | 1200        | 7              | 8.40              | 52           | €87.72        |

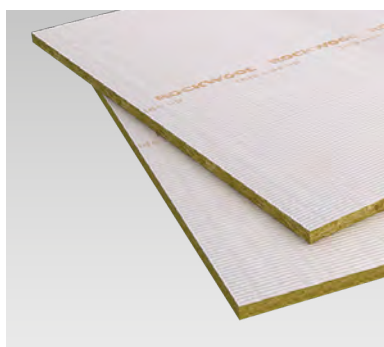

## HardRock® Multi-Fix Recovery Board

HardRock® Multi-Fix Recovery Board has been purposely designed to simplify the repair and refurbishment of flat roof systems. The product can be used to isolate and prepare the surface of existing roof systems, providing a level surface for the installation of new waterproofing membranes.

HardRock® Multi-Fix Recovery Board is compatible with all commonly used flat roof membranes, including single ply, EPDM, bitumen and liquid membrane systems (including GRP).

Lambda 0.039 W/mK

Pallet Size 1200 x 1000mm

| Product Code | Thickness (mm) | Width (mm) | Length (mm) | Pieces/ Pallet | Area/ Pallet (m²) | MOQ (Pallet) | List Price/m² |
|--------------|----------------|------------|-------------|----------------|-------------------|--------------|---------------|
| 174879       | 30             | 1000       | 1200        | 40             | 48                | 1            | €21.08        |

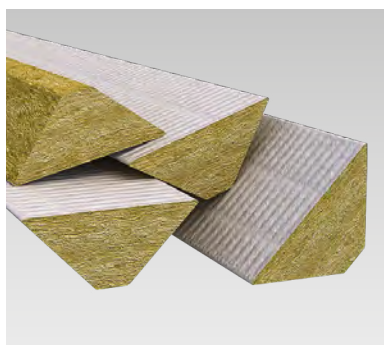

## HardRock® Multi-Fix Angle Fillet

Manufactured from high density, fire resilient ROCKWOOL insulation, and faced with a white mineral-coated glass fibre fleece, HardRock® Multi-Fix Angle Fillets are designed to fully support bituminous waterproof membranes at 90° abutments.

The smooth transitions allow water to run off freely, as opposed to holding in corners, where it could potentially seep into the building and cause structural damage.

Pallet Size 1200 x 1200mm

| Product Code | Thickness (mm) | Width (mm) | Length (mm) | Pieces/ Box | MOQ (Box) | List Price/ Linear m |
|--------------|----------------|------------|-------------|-------------|-----------|----------------------|
| 292007       | 30             | 75         | 1200        | 75          | 1         | €6.39                |



Orders for HardRock® UB34 & HardRock® Multi-Fix Angle Fillets cannot be used to contribute towards mixed loads. The lead times for these products can vary and will be confirmed on receipt of order. Additional carriage charges may be applied.

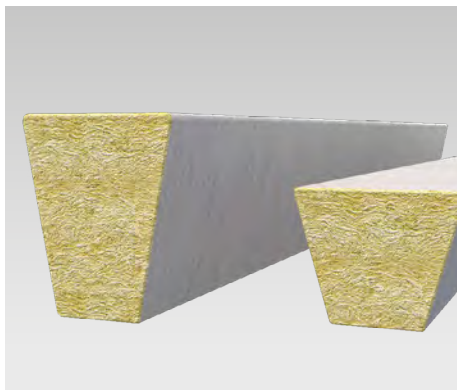

## Acoustic Infill

ROCKWOOL® Acoustic Infills consist of a trapezoidal shaped ROCKWOOL insulation which can be engineered to suit all types of perforated metal roof deck profiles.

Acoustic Infills provide a combination of optimised density, fibre direction and excellent fit to deliver significant levels of sound absorption, designed and tested for use within ROCKWOOL HardRock® roof systems.

*Acoustic Infills for different deck types, such as those from Joricide, Euro Clad, and Firth Steels, can be made to order subject to minimum order quantities. For further details please contact your local ROCKWOOL sales representative.*

Tissue Faced White

Pallet Size 1200 x 1000mm

| Product Code | Deck Type | Length (mm) | Major (mm) | Minor (mm) | Thickness (mm) | Pieces/ Pallet | MOQ (Pallet) | List Price/ Linear m |
|--------------|-----------|-------------|------------|------------|----------------|----------------|--------------|----------------------|
| 303802       | TATA D32  | 1200        | 68         | 23         | 25             | 952            | 1            | €6.83                |
| 303922       | TATA D46  | 1200        | 116        | 63         | 40             | 340            | 1            | €9.24                |
| 303994       | TATA D60  | 1200        | 106        | 60         | 50             | 275            | 1            | €9.82                |
| 303997       | TATA D100 | 1200        | 120        | 59         | 97             | 140            | 1            | €12.32               |
| 303999       | TATA D137 | 1200        | 161        | 39         | 125            | 90             | 1            | €15.99               |
| 304799       | TATA D153 | 1200        | 157        | 36         | 150            | 81             | 1            | €16.07               |
| 304800       | TATA D158 | 1200        | 128        | 37         | 150            | 99             | 1            | €16.07               |
| 304802       | TATA D159 | 1200        | 138        | 34         | 150            | 99             | 1            | €15.55               |
| 304804       | TATA D200 | 1200        | 166        | 71         | 195            | 56             | 1            | €20.91               |



Acoustic infill orders cannot be used to contribute towards mixed loads.  
Lead times for these products can vary and will be confirmed on receipt of order.  
Additional carriage charges may be applied.

# Flat roofs: The functional fifth façade

## Mitigating fire risk above and below modern flat roofs.

Today's flat roofs are increasingly used as multifunctional spaces for social and practical applications, including solar energy installations.

This expanding remit, particularly in crowded urban areas, brings multifaceted challenges to specification and building design.

Learn to mitigate the risks.

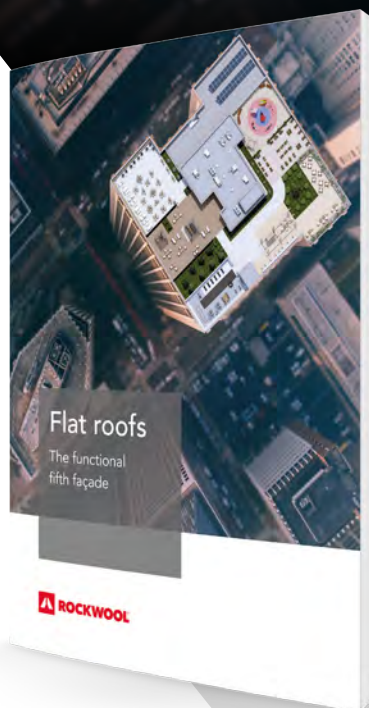

Download the  
whitepaper:



[rockwool.com/uk/  
functionalloofs](https://rockwool.com/uk/functionalloofs)



[< Back to Contents Page](#)

  
[rockwool.com/uk](https://rockwool.com/uk)

T: 00 44 1656 868 400

29



# Floor Solutions

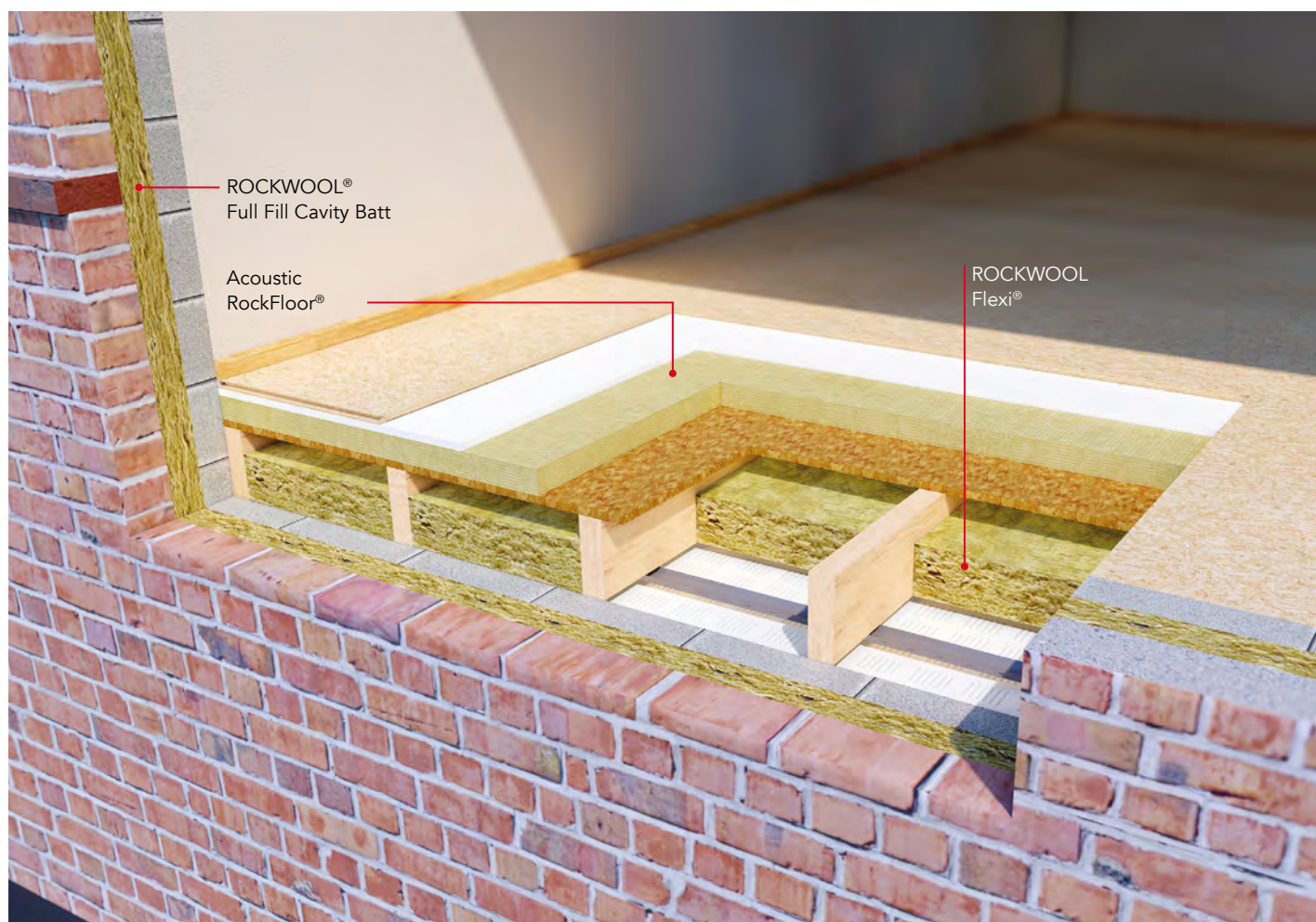

**ROCKWOOL insulation offers solutions for all types of floor, including ground floors, separating floors and intermediate floors.**

Energy efficiency and sound management are key to creating comfortable and healthy working and living environments. The thermal and acoustic performance of floor systems is an essential consideration when developing specifications for all building types.

Specifying Thermal RockFloor® within ground floor applications and Acoustic RockFloor® to separating floors ensures the right level of performance is delivered where it matters, creating comfortable indoor climates for building occupants.

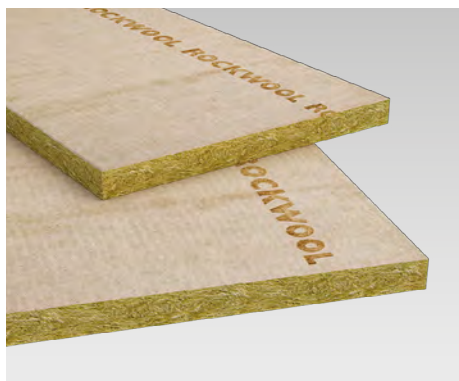

## RockFloor®

RockFloor® solutions are split into two families; Thermal RockFloor®, designed for the thermal insulation of ground and separating floors, and Acoustic RockFloor®, designed to provide high levels of sound absorption in internal and separating floors.

The unique dual density structure of Thermal RockFloor® means the slabs are able to absorb sub-floor imperfections on one side, and provide a high level of compressive strength on the other. The slabs are also easy to handle and fit.

## Acoustic RockFloor®

Pallet size 1200 x 1000mm

| Product Code | Thickness (mm) | Width (mm) | Length (mm) | Boards/ Pallet | Area/ Pallet (m²) | Made to Order | MOQ (Pallet) | List Price/m² |
|--------------|----------------|------------|-------------|----------------|-------------------|---------------|--------------|---------------|
| 122663       | 25             | 600        | 1000        | 96             | 57.60             |               |              | €43.82        |
| 122664       | 30             | 600        | 1000        | 80             | 48.00             |               |              | €52.74        |
| 122666       | 50             | 600        | 1000        | 48             | 28.80             |               |              | €87.92        |

## Thermal RockFloor®

Lambda 0.038 W/mK

Pallet size 1200 x 1000mm

| Product Code | Thickness (mm) | Width (mm) | Length (mm) | Boards/ Pallet | Area/ Pallet (m²) | Made to Order | MOQ (Pallet) | List Price/m² |
|--------------|----------------|------------|-------------|----------------|-------------------|---------------|--------------|---------------|
| 125051       | 50             | 600        | 1000        | 48             | 28.80             |               |              | €56.77        |
| 125054       | 80             | 600        | 1000        | 30             | 18.00             | •             | 16           | €73.42        |
| 125056       | 100            | 600        | 1000        | 24             | 14.40             |               |              | €96.58        |





# Roll Products

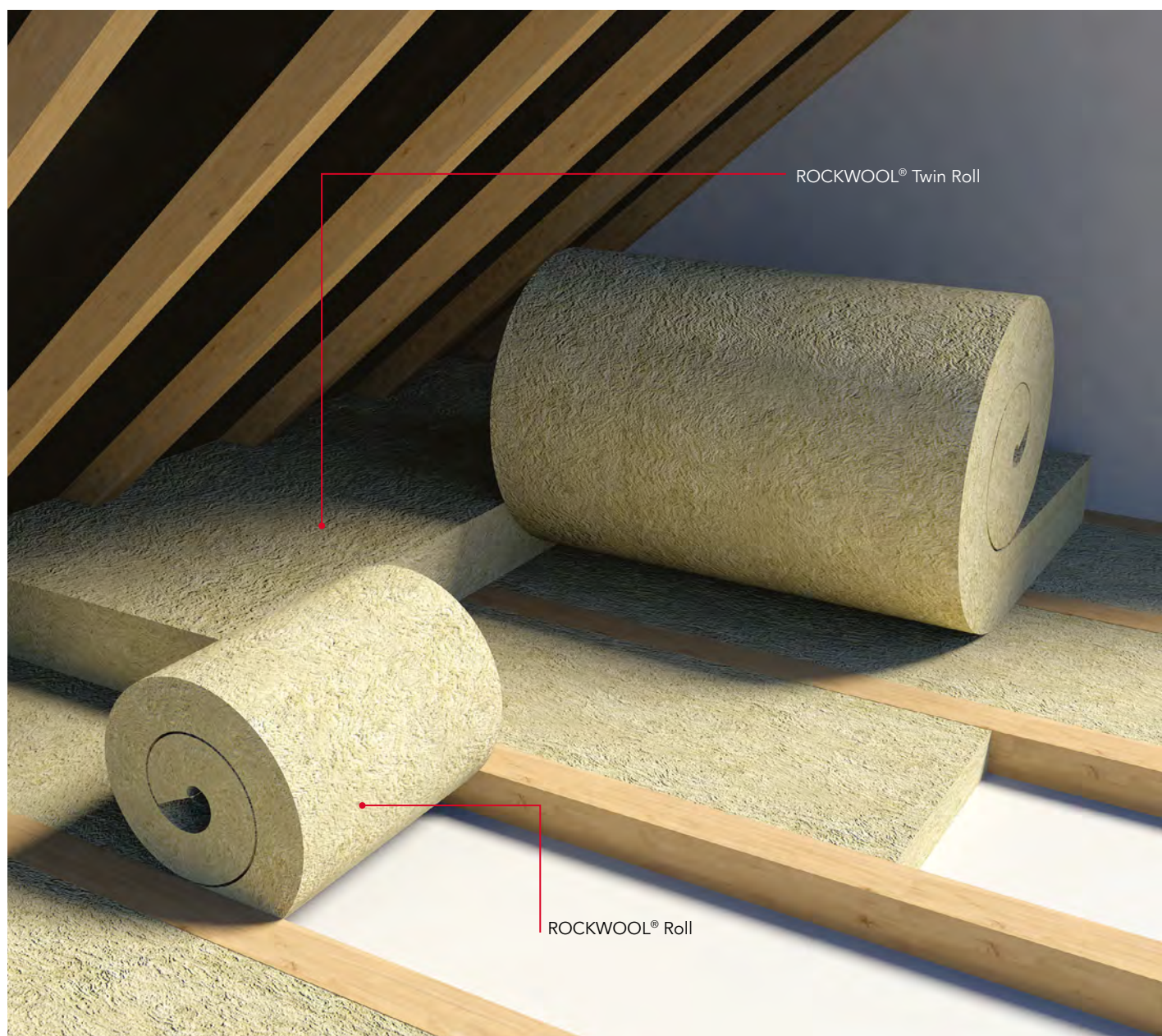

Installing the right insulation can go a long way to keeping homes warm throughout the winter months. According to the Energy Savings Trust, a quarter of heat is lost through the roof of an uninsulated home.

A well-insulated loft space can prevent heat escaping homes through the roof resulting in a warmer home. Energy-efficient homes tend to have reduced energy bills and a more comfortable living environment.

When choosing loft insulation, it is important to ensure the right thickness of insulation is installed. The current building guidelines recommend 300mm insulation thickness, but in many homes currently, there is as little as 100mm. This can be particularly true for older houses. Insulation performance plays an important role when choosing the right insulation, factors such as fire resistance and moisture repellence are often overlooked but can make a difference in the lifespan of the insulation material.

ROCKWOOL insulation is renowned for its excellent characteristics in these areas, making it an effective loft insulation solution for the lifetime of the building.



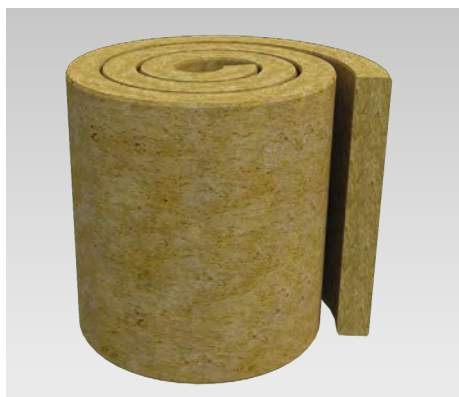

## ROLL Products

ROCKWOOL® Twin Roll, Roll and Rollbatt products provide excellent medium density thermal and acoustic insulation. The products are suitable for a wide range of applications including roof spaces in all types of building and as an overlay for ceiling tiles in suspended ceilings.

ROCKWOOL® Roll products are all non-combustible (Euroclass A1).

### Twin Roll

Lambda 0.044 W/mK

Pallet Size 1200 x 1200mm

| Product Code | Thickness (mm) | Width (mm) | Length (mm) | Pieces/ Pack | Packs/ Pallet | Area/ Pallet (m²) | List Price/m² |
|--------------|----------------|------------|-------------|--------------|---------------|-------------------|---------------|
| 125063       | 100            | 1200       | 2750        | 2            | 18            | 118.80            | €14.09        |

### Roll

Pallet Size 1200 x 1200mm

| Product Code | Thickness (mm) | Width (mm) | Length (mm) | Pieces/ Pack | Packs/ Pallet | Area/ Pallet (m²) | List Price/m² |
|--------------|----------------|------------|-------------|--------------|---------------|-------------------|---------------|
| 339822       | 150            | 1200       | 3200        | 1            | 18            | 69.12             | €21.87        |

### Rollbatt

Pallet Size 1200 x 1200mm

| Product Code | Thickness (mm) | Width (mm) | Length (mm) | Pieces/ Pack | Packs/ Pallet | Area/ Pallet (m²) | List Price/m² |
|--------------|----------------|------------|-------------|--------------|---------------|-------------------|---------------|
| 124625       | 100            | 400        | 4800        | 3            | 18            | 103.68            | €14.19        |
| 124626       | 100            | 600        | 4800        | 2            | 18            | 103.68            | €14.19        |
| 339692       | 150            | 400        | 3200        | 3            | 18            | 69.12             | €21.87        |
| 339691       | 150            | 600        | 3200        | 2            | 18            | 69.12             | €21.87        |

# Slab Products



The ROCKWOOL Slab Insulation ranges provide excellent thermal, acoustic and fire insulation (Euroclass A1) for the general building market, in multiple applications including floors, walls and roofs.

ROCKWOOL slabs are easy to handle and install, are highly durable and do not slump. The Product ranges consist of high quality resin bonded slabs in a variety of thicknesses and densities.

The ROCKWOOL Slab Range is CE marked according to EN 13162:2012 +A1:2015.

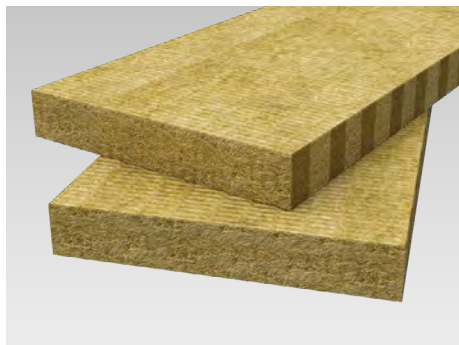

## Flexi®

Flexi® is a multi-use, dual purpose thermal and acoustic insulation product with a unique flexible edge along one side. The patented flexible edge ensures a perfect fit is maintained between the product and its supporting framework for easy installation and optimum effectiveness.

Lambda 0.038 W/mK (50 - 120mm) - 0.035 W/mK (≥140mm)

Pallet Size 1200 x 1200mm

| Product Code | Thickness (mm) | Width (mm) | Length (mm) | Pieces/ Pack | Area/ Pack (m²) | Packs/ Pallet | Area/ Pallet (m²) | Made to Order | MOQ (Pallet) | List Price/m² |
|--------------|----------------|------------|-------------|--------------|-----------------|---------------|-------------------|---------------|--------------|---------------|
| 274366       | 50             | 400        | 1200        | 12           | 5.76            | 24            | 138.24            |               |              | €12.27        |
| 274404       | 50             | 600        | 1200        | 12           | 8.64            | 16            | 138.24            |               |              | €12.27        |
| 123320       | 60             | 600        | 1200        | 12           | 8.64            | 12            | 103.68            |               |              | €15.00        |
| 123322       | 70             | 600        | 1200        | 8            | 5.76            | 16            | 92.16             |               |              | €17.00        |
| 123324       | 90             | 600        | 1200        | 6            | 4.32            | 20            | 86.40             |               |              | €21.41        |
| 123325       | 100            | 400        | 1200        | 6            | 2.88            | 30            | 86.40             |               |              | €24.34        |
| 123326       | 100            | 600        | 1200        | 6            | 4.32            | 20            | 86.40             |               |              | €24.34        |
| 123328       | 120            | 600        | 1200        | 6            | 4.32            | 16            | 69.12             | •             | 22           | €29.17        |
| 123329       | 140            | 400        | 1200        | 4            | 1.92            | 24            | 46.08             |               |              | €34.15        |
| 123330       | 140            | 600        | 1200        | 4            | 2.88            | 16            | 46.08             |               |              | €34.15        |
| 163833       | 180            | 600        | 1200        | 3            | 2.16            | 12            | 25.92             |               |              | €43.90        |



## RW Slab Range

The versatile ROCKWOOL RW slab range is used for thermal, acoustic and fire insulation in general building applications.

A range of alternative sizes and facings (tissue and foil) are available on request subject to minimum order quantities.

## RWA45

Lambda 0.035 W/mK

Pallet Size 1200 x 1200mm

| Product Code | Thickness (mm) | Width (mm) | Length (mm) | Pieces/ Pack | Area/ Pack (m²) | Packs/ Pallet | Area/ Pallet (m²) | Made to Order | MOQ (Pallet) | List Price/m² |
|--------------|----------------|------------|-------------|--------------|-----------------|---------------|-------------------|---------------|--------------|---------------|
| 181173       | 25             | 600        | 1200        | 16           | 11.52           | 12            | 138.24            |               |              | €6.28         |
| 181174       | 30             | 600        | 1200        | 12           | 8.64            | 16            | 138.24            |               |              | €7.61         |
| 181175       | 40             | 600        | 1200        | 12           | 8.64            | 16            | 138.24            |               |              | €10.15        |
| 181176       | 50             | 600        | 1200        | 9            | 6.48            | 16            | 103.68            |               |              | €12.64        |
| 181177       | 60             | 600        | 1200        | 8            | 5.76            | 16            | 92.16             |               |              | €15.22        |
| 209290       | 75             | 600        | 1200        | 6            | 4.32            | 20            | 86.40             |               |              | €19.02        |
| 209274       | 100            | 600        | 1200        | 4            | 2.88            | 20            | 57.60             |               |              | €25.13        |



## RW3

Lambda 0.034 W/mK

Pallet size 1200 x 1200mm

|   | Product Code | Thickness (mm) | Width (mm) | Length (mm) | Pieces/ Pack | Area/ Pack (m <sup>2</sup> ) | Packs/ Pallet | Area/ Pallet (m <sup>2</sup> ) | Made to Order | MOQ (Pallet) | List Price/m <sup>2</sup> |
|---|--------------|----------------|------------|-------------|--------------|------------------------------|---------------|--------------------------------|---------------|--------------|---------------------------|
|   | 181180       | 25             | 600        | 1200        | 16           | 11.52                        | 12            | 138.24                         |               |              | €8.23                     |
|   | 181181       | 30             | 600        | 1200        | 15           | 10.80                        | 12            | 129.60                         |               |              | €9.91                     |
|   | 181182       | 40             | 600        | 1200        | 10           | 7.20                         | 12            | 86.40                          |               |              | €13.12                    |
|   | 181183       | 50             | 600        | 1200        | 8            | 5.76                         | 12            | 69.12                          |               |              | €16.37                    |
|   | 181184       | 60             | 600        | 1200        | 6            | 4.32                         | 12            | 51.84                          |               |              | €19.64                    |
|   | 181185       | 75             | 600        | 1200        | 6            | 4.32                         | 12            | 51.84                          |               |              | €24.56                    |
|   | 237922       | 90             | 600        | 1200        | 5            | 3.60                         | 12            | 43.20                          |               |              | €26.04                    |
|   | 181186       | 100            | 600        | 1200        | 4            | 2.88                         | 12            | 34.56                          |               |              | €32.99                    |
| * | 181188       | 50             | 600        | 1000        | 8            | 4.80                         | 15            | 72.00                          | •             | 22           | €19.52                    |
| □ | 181189       | 30             | 600        | 1000        | 10           | 6.00                         | 20            | 120.00                         | •             | 22           | €16.48                    |
| ■ | 181244       | 100            | 600        | 1000        | 4            | 2.40                         | 15            | 36.00                          | •             | 22           | €48.49                    |

**KEY:** \* Black Tissue Faced   □ White Tissue Faced   ■ Foil Faced

## RW4

Lambda 0.034 W/mK

Pallet size 2400 x 1200mm

| Product Code | Thickness (mm) | Width (mm) | Length (mm) | Pieces/ Pack | Area/ Pack (m <sup>2</sup> ) | Packs/ Pallet | Area/ Pallet (m <sup>2</sup> ) | Made to Order | MOQ (Pallet) | List Price/m <sup>2</sup> |
|--------------|----------------|------------|-------------|--------------|------------------------------|---------------|--------------------------------|---------------|--------------|---------------------------|
| 181191       | 50             | 600        | 1200        | 6            | 4.32                         | 16            | 69.12                          | •             | 22           | €16.77                    |
| 181192       | 75             | 600        | 1200        | 4            | 2.88                         | 16            | 46.08                          | •             | 22           | €25.01                    |
| 181193       | 100            | 600        | 1200        | 3            | 2.16                         | 16            | 34.56                          |               |              | €33.48                    |

## RW5

Lambda 0.034 W/mK

Pallet size 2400 x 1200mm

| Product Code | Thickness (mm) | Width (mm) | Length (mm) | Pieces/ Pack | Area/ Pack (m <sup>2</sup> ) | Packs/ Pallet | Area/ Pallet (m <sup>2</sup> ) | Made to Order | MOQ (Pallet) | List Price/m <sup>2</sup> |
|--------------|----------------|------------|-------------|--------------|------------------------------|---------------|--------------------------------|---------------|--------------|---------------------------|
| 181194       | 25             | 600        | 1200        | 8            | 5.76                         | 24            | 138.24                         |               |              | €12.29                    |
| 181195       | 30             | 600        | 1200        | 8            | 5.76                         | 20            | 115.20                         |               |              | €14.78                    |
| 181197       | 50             | 600        | 1200        | 4            | 2.88                         | 24            | 69.12                          |               |              | €24.82                    |
| 181199       | 75             | 600        | 1200        | 3            | 2.16                         | 20            | 43.20                          |               |              | €37.05                    |
| 181200       | 100            | 600        | 1200        | 2            | 1.44                         | 24            | 34.56                          |               |              | €49.24                    |

| Product Code | Thickness (mm) | Width (mm) | Length (mm) | Slabs/ Pallet | Area/ Pallet (m <sup>2</sup> ) | Made to Order | MOQ (Pallet) | List Price/m <sup>2</sup> |
|--------------|----------------|------------|-------------|---------------|--------------------------------|---------------|--------------|---------------------------|
| 181265       | 150            | 600        | 1200        | 32            | 23.04                          | •             | 22           | €74.95                    |



# Why choose ROCKWOOL stone wool insulation?

At ROCKWOOL, we have been manufacturing for more than 40 years.

Our stone wool insulation is made from a natural and abundant material - volcanic rock.

This provides a unique combination of benefits that are the foundation of our business.



## Fire resilience

Stone wool insulation can tolerate temperatures up to 1,000°C and will not burn.



## Robustness

The dimensional stability of stone wool insulation means reliable, long-term performance.



## Thermal properties

ROCKWOOL insulation provides thermal performance, reducing bills and enhancing indoor comfort.



## Water repellence

Stone wool insulation is water resistant and can help to prevent damp and mould.



## Acoustic capabilities

The structure and density of ROCKWOOL insulation means it traps sound waves and absorbs vibrations.



## Circularity

Volcanic rock is one of the most abundant materials on the planet. Stone wool is both reusable and recyclable.



**ROCKWOOL®**





# Structural and Cavity Fire Protection Solutions



In the event of a fire, our tested fire protection solution slows the spread of the flames. ROCKWOOL stone wool does not produce any significant toxic smoke and also helps protect the building's load-bearing structure, protecting lives and investment.

By protecting the structural frame of the building from destruction by fire, it is possible to give occupants more time to escape, and to limit damage to the building.

ROCKWOOL stone wool insulation can tolerate temperatures in excess of 1000°C and is the ideal material for fire protection.



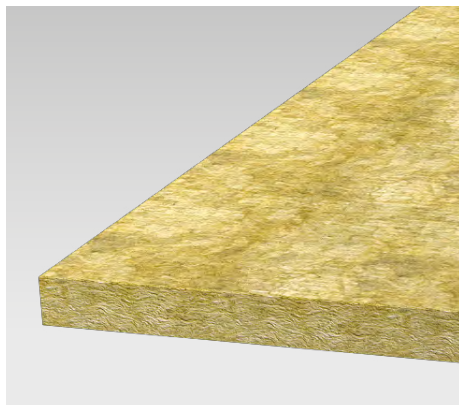

## BeamClad®

ROCKWOOL BeamClad® is a non-combustible stone wool insulation slab, designed and tested to provide up to 4 hours' protection to structural steel.\*

### Benefits:

- Up to 4 hours' fire resistance\*
- Dry-fix or adhered installation
- Moisture repellent
- No maintenance

\*Subject to the application.

## BeamClad®

Pallet size 2000 x 1200mm

| Product Code | Additional Information | Thickness (mm) | Width (mm) | Length (mm) | Pieces/Pallet | Area/Pallet (m²) | Made to Order | MOQ (Pallet) | List Price/m² |
|--------------|------------------------|----------------|------------|-------------|---------------|------------------|---------------|--------------|---------------|
| 122706       | Plain                  | 25             | 1200       | 2000        | 45            | 108.00           |               |              | €39.65        |
| 122708       | Plain                  | 30             | 1200       | 2000        | 40            | 96.00            | •             | 8            | €56.16        |
| 122709       | Plain                  | 35             | 1200       | 2000        | 32            | 76.80            | •             | 8            | €66.46        |
| 122710       | Plain                  | 40             | 1200       | 2000        | 30            | 72.00            |               |              | €74.85        |
| 122711       | Plain                  | 50             | 1200       | 2000        | 24            | 57.60            | •             | 6            | €93.49        |
| 122698       | Foil Faced             | 25             | 1200       | 2000        | 45            | 108.00           | •             | 4            | €50.35        |
| 122699       | Foil Faced             | 30             | 1200       | 2000        | 40            | 96.00            | •             | 4            | €66.88        |
| 122701       | Foil Faced             | 40             | 1200       | 2000        | 30            | 72.00            | •             | 4            | €85.55        |
| 254656       | Foil Faced             | 50             | 1200       | 2000        | 24            | 57.60            | •             | 6            | €104.14       |



## FirePro® Glue

ROCKWOOL FirePro® Glue is a specially formulated water-based fire resistant adhesive for use within ROCKWOOL fire protection systems and also other suitable ROCKWOOL products where a fire resistant adhesive is needed.

### Benefits:

- Up to 4 hours fire protection
- Listed on the LUL Product Register
- Easy to apply
- Can use from 10°C upwards
- Cures in as little as 4 hours

| Product Code | Tub Size (kg) | Tubs/Pallet | MOQ (Tub) | List Price/Tub |
|--------------|---------------|-------------|-----------|----------------|
| 128034       | 17            | 48          | 1         | €174.27        |

| Product Code | Cartridge Size (ml) | Cartridges/(Pack) | MOQ (Pack) | List Price/Pack |
|--------------|---------------------|-------------------|------------|-----------------|
| 276658       | 300                 | 12                | 1          | €135.90         |

Approximate coverage 10.2m²/tub subject to application thickness.

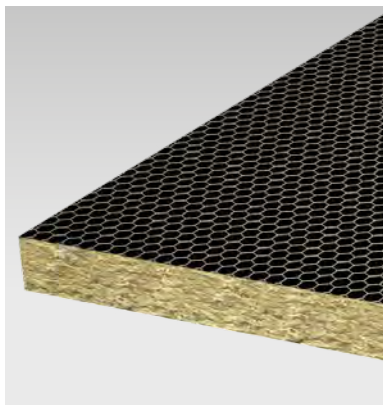

## Fire Barrier EN

ROCKWOOL Fire Barrier EN is a wire-reinforced high density stone wool roll designed for inhibiting the passage of fire and smoke through extensive cavities within buildings.

The product has been classified to BS EN 13501-2:2016 based on testing to the following standards:

- BS EN 1364-1:2015
- BS EN 1634-1:2014+A1:2018

For further details please see the product's UL Classification Reports available on our website.

## Fire Barrier

Pallet size 1200 x 1200mm

| Product Code | Foil Facing | Thickness (mm) | Width (mm) | Length (mm) | Rolls/ Pack | Area/ Pack (m²) | Packs/ Pallet | Area/ Pallet (m²) | MOQ (Pallet) | List Price/m² |
|--------------|-------------|----------------|------------|-------------|-------------|-----------------|---------------|-------------------|--------------|---------------|
| 351875       | 1 side      | 50             | 1000       | 3800        | 1           | 3.80            | 21            | 79.80             | 1            | €45.17        |
| 351879       | 2 sides     | 50             | 1000       | 3800        | 1           | 3.80            | 21            | 79.80             | 1            | €54.86        |

## Fire Barrier EN Fixings

| Product Code | Item                           | Thickness (mm) | Length (mm) | Pieces/ Pack | MOQ (Pallet) | List Price/ Pack |
|--------------|--------------------------------|----------------|-------------|--------------|--------------|------------------|
| 352076       | Fire Barrier EN Angle Support  | 2.0            | 1000        | 10           | 1            | €263.91          |
| 352074       | Fire Barrier EN Clamping Plate | 2.0            | 1000        | 10           | 1            | €146.80          |

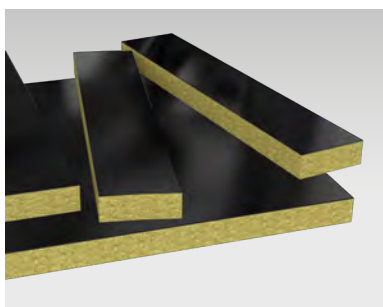

## SP FireStop EN

SP FireStop EN comprises of a stone wool slab faced with high emissivity black aluminium foil on both sides and is supplied in two thickness options depending on the fire rating required.

SP FireStop EN has been tested in accordance with BS EN 1366-4:2021 and is suitable for use as a linear cavity firestop in both vertical and horizontal orientations.

Benefits:

- Tested against an SFS substrate both horizontally and vertically
- Up to EI 120 in cavities up to 600mm\*
- Resists the passage of smoke - black aluminium foil on both sides

## SP FireStop EN Slab

Pallet size 2000 x 1200mm

| Product Code | Fire Rating (Up to Mins) | Thickness (mm) | Width (mm) | Length (mm) | Pieces/ Pallet | Area/ Pallet (m²) | MOQ (Pallet) | List Price/m² |
|--------------|--------------------------|----------------|------------|-------------|----------------|-------------------|--------------|---------------|
| 336804       | 60                       | 75             | 1000       | 1200        | 32             | 38.4              | 1            | €239.36       |
| 333802       | 120                      | 90             | 1000       | 1200        | 24             | 28.8              | 1            | €253.80       |

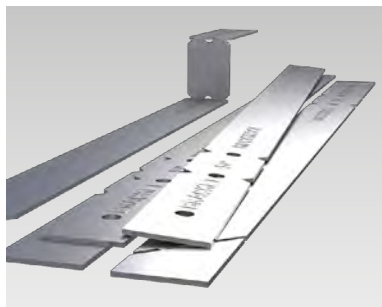

## SP FireStop Fixing Brackets

ROCKWOOL SP Fixing Brackets are supplied in three standard sizes; SP/S (small), SP/L (large) and \*SP/XL for cavity widths up to 600mm. The brackets are supplied in cardboard boxes of 50 pieces, flat packed and designed to be easily re-profiled by hand on site.

*\*SP/XL brackets are designed for use with SP FireStop Plus Slab® for 2 hours fire resistance in cavities up to 600mm.*

### SP FireStop Fixing Brackets

| Product Code | Additional Information | Cavity Size (Up to mm) | Unit | Pieces/ Pack | MOQ (Pack) | List Price/ Pack |
|--------------|------------------------|------------------------|------|--------------|------------|------------------|
| 128709       | SP/S (small)           | 100                    | Pack | 50           | 1          | €243.04          |
| 128710       | SP/L (large)           | 400                    | Pack | 50           | 1          | €283.64          |
| 259890       | SP/XL (extra large)    | 600                    | Pack | 50           | 1          | €495.65          |

### SP FireStop Fixing Brackets - Stainless Steel

| Product Code | Additional Information | Cavity Size (Up to mm) | Unit | Pieces/ Pack | MOQ (Pack) | List Price/ Pack |
|--------------|------------------------|------------------------|------|--------------|------------|------------------|
| 318285       | SP Small SS            | 100                    | Pack | 50           | 1          | €320.07          |
| 318287       | SP Large SS            | 400                    | Pack | 50           | 1          | €621.37          |
| 318289       | SP Xlarge SS           | 600                    | Pack | 50           | 1          | €931.39          |

Carriage charges for SP Firestop Fixing Brackets - Stainless Steel may apply and will be confirmed on receipt of order.

Carriage charges will be waived for Stainless Steel SP Fixing Bracket orders in excess of £1500.

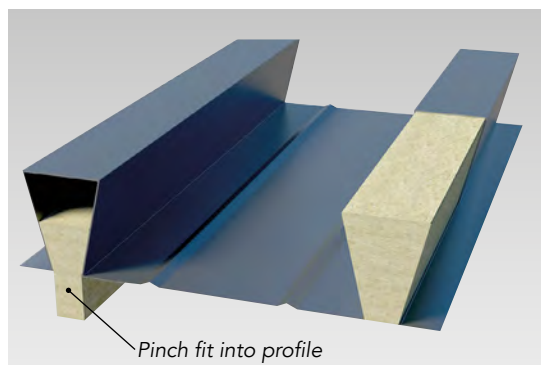

## Dovetail Infill

ROCKWOOL Dovetail Infills are made from medium density non combustible stone wool. Designed to allow adequate compression for 'pinch fit' into the profile yet it retains the necessary lateral stiffness to aid installation.

Deck profile to be named at time of order.

Length 300mm

| To Suit Deck Manufacturer | To Suit Profile | Major (mm) | Minor (mm) | Height (mm) | Made to Order | List Price/ Each |
|---------------------------|-----------------|------------|------------|-------------|---------------|------------------|
| Kingspan                  | MD50            | 40         | 15         | 50          | •             | €4.38            |
| Kingspan                  | MD60            | 53         | 50         | 9           | •             | €3.68            |
| Kingspan                  | MD80            | 53         | 50         | 9           | •             | €3.68            |
| NSD                       | MF55            | 41         | 17         | 55          | •             | €4.38            |
| NSD                       | MF60            | 45         | 45         | 15          | •             | €3.68            |
| Richard Lees              | Superib         | 40         | 15         | 51          |               | €3.68            |
| Richard Lees              | ED60            | 48         | 42         | 10          | •             | €3.68            |
| SMD                       | R51+            | 40         | 13         | 52          | •             | €4.38            |
| TATA                      | CF51+           | 38         | 15         | 51          | •             | €4.38            |
| TATA                      | CF60            | 50         | 47         | 15          | •             | €3.68            |
| TATA                      | CF80            | 50         | 47         | 15          | •             | €3.68            |

Dovetail Infills may incur additional carriage charges, for further information please contact the ROCKWOOL Customer Support Centre.





## Linear Firestops

Linear Firestops provide firestopping at the junctions of compartment walls and floors. Tested to BS EN 1366-4 and BS EN 1366-3, they provide up to 4 hours\* fire integrity, fitted as rectangular pieces that tightly butt joint and must be compressed by at least 5% in thickness to ensure a secure fit.

### Benefits:

- Provides up to 4 hours\* fire integrity
- Available in small quantities

*\*Subject to the application.*

| Width<br>(mm) | List Price/linear metre by thickness |               |               |               |               |               | Length<br>1200mm |
|---------------|--------------------------------------|---------------|---------------|---------------|---------------|---------------|------------------|
|               | 15mm<br>Price                        | 25mm<br>Price | 30mm<br>Price | 40mm<br>Price | 50mm<br>Price | 60mm<br>Price | Made<br>to Order |
| 75            | €3.03                                | €5.17         | €5.56         | €7.37         | €9.31         | €11.18        | •                |
| 100           | €3.56                                | €5.94         | €6.45         | €8.57         | €10.78        | €13.40        | •                |
| 120           | €3.71                                | €6.30         | €6.78         | €9.09         | €11.48        | €13.78        | •                |
| 140           | €4.36                                | €7.37         | €7.95         | €10.51        | €12.05        | €14.40        | •                |
| 150           | €4.50                                | €7.53         | €8.07         | €10.56        | €13.37        | €15.99        | •                |
| 160           | €4.63                                | €7.71         | €8.33         | €11.10        | €14.08        | €16.77        | •                |
| 170           | €4.79                                | €8.13         | €8.77         | €11.62        | €14.77        | €17.67        | •                |
| 180           | €5.11                                | €8.51         | €9.19         | €12.26        | €15.49        | €18.51        | •                |
| 190           | €5.29                                | €8.93         | €9.68         | €12.83        | €16.33        | €19.46        | •                |
| 200           | €5.66                                | €9.48         | €10.26        | €13.53        | €17.23        | €20.62        | •                |

*In addition to the sizes shown ROCKWOOL manufacture a wide range of linear and trapezoidal firestop pieces to suit most applications. Linear Firestops may incur additional carriage charges, for further information please contact the ROCKWOOL Customer Support Centre.*



## Trapezoidal Firestops

Trapezoidal Firestops prevent the passage of fire and smoke in the deck at the junction of compartment walls and floors. Manufactured slightly oversized to the deck profile ensure tight gap free fit.

Deck profile to be named at the time of order. alternatively, if deck brand is unknown measurements detailed on the left must be provided.

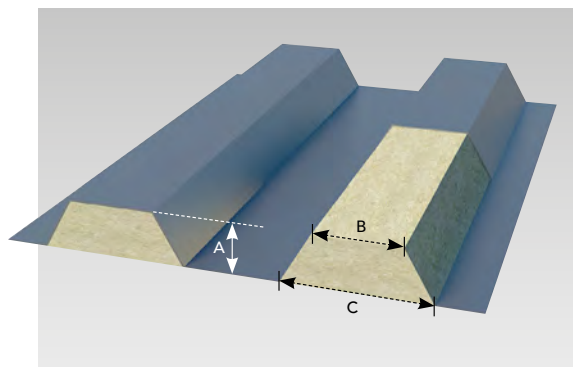

Length 1200mm

| To Suit Deck Manufacturer | To Suit Profile | Height (A) (mm) | Minor (B) (mm) | Major (C) (mm) | Made to Order | List Price/ Linear m |
|---------------------------|-----------------|-----------------|----------------|----------------|---------------|----------------------|
| Kingspan                  | MD60            | 61              | 142            | 213            | •             | €16.97               |
| Kingspan                  | MD80            | 80.5            | 131            | 198            | •             | €23.38               |
| NSD                       | MF60            | 60              | 130            | 175            | •             | €19.18               |
| NSD                       | MF80            | 80              | 130            | 175            | •             | €24.07               |
| Richard Lees              | Ribdeck S60     | 60              | 130.7          | 180            | •             | €12.13               |
| Richard Lees              | E60             | 60              | 153            | 223            | •             | €19.18               |
| Richard Lees              | RD80            | 80              | 115            | 180            | •             | €23.38               |
| SMD                       | TR60+           | 60              | 158            | 200            | •             | €19.18               |
| SMD                       | TR80+           | 80              | 137            | 178            | •             | €23.38               |
| TATA                      | CF60            | 60              | 131            | 180            | •             | €19.18               |
| TATA                      | CF80            | 80              | 150            | 180            | •             | €23.38               |
| TATA                      | D35             | 35              | 75             | 115            | •             | €11.44               |
| TATA                      | D46             | 46              | 105            | 158            | •             | €17.68               |
| TATA                      | D60             | 60              | 90             | 136            | •             | €16.97               |
| TATA                      | D100            | 100             | 109            | 170.3          | •             | €31.68               |
| TATA                      | D135            | 137             | 145            | 267            | •             | €47.79               |
| TATA                      | D153            | 153             | 119            | 240            | •             | €48.94               |
| TATA                      | D159            | 159             | 108            | 212            | •             | €48.94               |

Linear and Trapezoidal Firestop orders cannot be used to contribute towards mixed loads.

The lead times for these products can vary and will be confirmed on receipt of order.

Trapezoidal Firestops may incur additional carriage charges, for further information please contact the ROCKWOOL Customer Support Centre.



## SCB

ROCKWOOL SCB (Sleeved Cavity Barrier) consists of a stone wool insulation strip encapsulated in a protective polythene sleeve. Fitted under compression, the product acts to inhibit the passage of smoke and fire within masonry, timber- and steel frame constructions.

ROCKWOOL SCB has been tested in accordance with BS EN 1364-4:2021 and classified to BS EN 13501-2. For further details please see the product's UL Classification Report available on our website.

Product is supplied in bags packed into cardboard tubes secured on a 1200x1200mm pallet.

\*Thicknesses marked by an asterisk are supplied in cardboard boxes secured on a 1300x1200mm pallet.

Available in full pallet quantities only.

| Product Code | To Suit Cavity (mm) | Thickness (mm) | Width (mm) | Length (mm) | Pieces/ Bag | Pieces/ Pallet | Linear m/ Bag | Linear m/ Pallet | List Price/ Linear m |
|--------------|---------------------|----------------|------------|-------------|-------------|----------------|---------------|------------------|----------------------|
| 356250       | 50-55               | 65*            | 110        | 1200        | 23          | 138            | 27.6          | 165.6            | €7.91                |
|              | 56-65               | 75             | 110        | 1200        | 20          | 320            | 24            | 384              | €11.17               |
|              | 66-75               | 85             | 110        | 1200        | 14          | 280            | 16.8          | 336              | €11.26               |
|              | 76-90               | 100            | 110        | 1200        | 15          | 240            | 18            | 288              | €11.37               |
| 356262       | 91-100              | 110*           | 110        | 1200        | 14          | 84             | 16.8          | 100.8            | €11.44               |
|              | 101-110             | 120            | 110        | 1200        | 10          | 200            | 12            | 240              | €15.34               |
|              | 111-120             | 130            | 110        | 1200        | 12          | 180            | 14.4          | 216              | €16.90               |
|              | 121-130             | 140            | 110        | 1200        | 8           | 160            | 9.6           | 192              | €18.46               |
|              | 131-140             | 150            | 110        | 1200        | 10          | 160            | 12            | 192              | €20.02               |
| 356263       | 141-150             | 160*           | 110        | 1200        | 9           | 54             | 10.8          | 64.8             | €21.58               |
|              | 151-160             | 170            | 110        | 1200        | 5           | 140            | 6             | 168              | €24.32               |
|              | 161-170             | 180            | 110        | 1200        | 5           | 140            | 6             | 168              | €24.51               |
|              | 171-180             | 190            | 110        | 1200        | 6           | 120            | 7.2           | 144              | €24.70               |
|              | 181-190             | 200            | 110        | 1200        | 6           | 120            | 7.2           | 144              | €24.88               |
|              | 191-200             | 210            | 110        | 1200        | 6           | 120            | 7.2           | 144              | €25.07               |
|              | 201-210             | 220            | 110        | 1200        | 5           | 100            | 6             | 120              | €26.30               |
|              | 211-220             | 230            | 110        | 1200        | 5           | 100            | 6             | 120              | €27.53               |
|              | 221-230             | 240            | 110        | 1200        | 5           | 100            | 6             | 120              | €27.68               |
|              | 231-240             | 250            | 110        | 1200        | 5           | 100            | 6             | 120              | €27.82               |
|              | 241-250             | 260            | 110        | 1200        | 5           | 80             | 6             | 96               | €27.97               |
|              | 251-260             | 270            | 110        | 1200        | 5           | 80             | 6             | 96               | €28.11               |
|              | 261-270             | 280            | 110        | 1200        | 4           | 80             | 4.8           | 96               | €28.26               |
|              | 271-280             | 290            | 110        | 1200        | 4           | 80             | 4.8           | 96               | €28.40               |
|              | 281-290             | 300            | 110        | 1200        | 4           | 80             | 4.8           | 96               | €28.55               |





## SCB

ROCKWOOL SCB (Sleeved Cavity Barrier) consists of a stone wool insulation strip encapsulated in a protective polythene sleeve. Fitted under compression, the product acts to inhibit the passage of smoke and fire within masonry, timber- and steel frame constructions.

ROCKWOOL SCB has been tested in accordance with BS EN 1364-4:2021 and classified to BS EN 13501-2. For further details please see the product's UL Classification Report available on our website.

Product is supplied in bags packed into cardboard tubes secured on a 1200x1200mm pallet.

\*Thicknesses marked by an asterisk are supplied in cardboard boxes secured on a 1300x1200mm pallet.

Available in full pallet quantities only.

| Product Code | To Suit Cavity (mm) | Thickness (mm) | Width (mm) | Length (mm) | Pieces/ Bag | Pieces/ Pallet | Linear m/ Bag | Linear m/ Pallet | List Price/ Linear m |
|--------------|---------------------|----------------|------------|-------------|-------------|----------------|---------------|------------------|----------------------|
| 356264       | 50-55               | 65*            | 200        | 1200        | 12          | 72             | 14.4          | 86.4             | €14.82               |
|              | 56-65               | 75             | 200        | 1200        | 10          | 180            | 12            | 216              | €21.54               |
|              | 66-75               | 85             | 200        | 1200        | 7           | 154            | 8.4           | 182.4            | €21.76               |
|              | 76-90               | 100            | 200        | 1200        | 6           | 132            | 7.2           | 158.4            | €21.98               |
| 356265       | 91-100              | 110*           | 200        | 1200        | 7           | 42             | 8.4           | 50.4             | €22.21               |
|              | 101-110             | 120            | 200        | 1200        | 6           | 108            | 7.2           | 129.6            | €26.19               |
|              | 111-120             | 130            | 200        | 1200        | 3           | 102            | 3.6           | 122.4            | €26.39               |
|              | 121-130             | 140            | 200        | 1200        | 6           | 96             | 7.2           | 115.2            | €26.59               |
|              | 131-140             | 150            | 200        | 1200        | 6           | 90             | 7.2           | 108              | €26.80               |
| 356266       | 141-150             | 160*           | 200        | 1200        | 5           | 30             | 6             | 36               | €26.99               |
|              | 151-160             | 170            | 200        | 1200        | 3           | 78             | 3.6           | 93.6             | €35.28               |
|              | 161-170             | 180            | 200        | 1200        | 4           | 72             | 4.8           | 86.4             | €35.50               |
|              | 171-180             | 190            | 200        | 1200        | 4           | 72             | 4.8           | 86.4             | €35.72               |
|              | 181-190             | 200            | 200        | 1200        | 3           | 66             | 3.6           | 79.2             | €35.94               |
|              | 191-200             | 210            | 200        | 1200        | 3           | 66             | 3.6           | 79.2             | €36.15               |
|              | 201-210             | 220            | 200        | 1200        | 3           | 60             | 3.6           | 72               | €36.37               |
|              | 211-220             | 230            | 200        | 1200        | 3           | 60             | 3.6           | 72               | €37.05               |
|              | 221-230             | 240            | 200        | 1200        | 3           | 54             | 3.6           | 64.8             | €37.33               |
|              | 231-240             | 250            | 200        | 1200        | 3           | 54             | 3.6           | 64.8             | €37.63               |
|              | 241-250             | 260            | 200        | 1200        | 3           | 48             | 3.6           | 57.6             | €37.92               |
|              | 251-260             | 270            | 200        | 1200        | 3           | 48             | 3.6           | 57.6             | €38.19               |
|              | 261-270             | 280            | 200        | 1200        | 3           | 48             | 3.6           | 57.6             | €38.34               |
|              | 271-280             | 290            | 200        | 1200        | 3           | 48             | 3.6           | 57.6             | €38.93               |
|              | 281-290             | 300            | 200        | 1200        | 2           | 44             | 2.4           | 52.8             | €39.51               |



## Soffit Slab

Soffit Slab is a non-combustible stone wool insulation designed for concrete soffits, offering thermal performance and fire resistance.

Benefits:

- Non-combustible.
- Water repellent.
- Up to 4 hours' fire resistance.\*
- High-Impact version features 6mm fibre cement facing board.

*\*Subject to the application.*

## Soffit Slab

Pallet size 2000 x 1200mm

| Product Code | Additional Information | Thickness (mm) | Width (mm) | Length (mm) | Pieces/ Pallet | Area/ Pallet (m <sup>2</sup> ) | Made to Order | MOQ (Pallet) | List Price/m <sup>2</sup> |
|--------------|------------------------|----------------|------------|-------------|----------------|--------------------------------|---------------|--------------|---------------------------|
| 272234       | Plain                  | 50             | 600        | 1000        | 96             | 57.6                           | •             | 8            | €34.77                    |
| 124809       | Plain                  | 130            | 600        | 1000        | 36             | 21.60                          |               |              | €65.05                    |
| 124813       | Plain                  | 160            | 600        | 1000        | 32             | 19.20                          |               |              | €80.12                    |
| 124802       | Foil faced             | 130            | 600        | 1000        | 36             | 21.60                          |               |              | €72.48                    |
| 124804       | Foil faced             | 145            | 600        | 1000        | 32             | 19.20                          | •             | 14           | €81.18                    |
| 124806       | Foil faced             | 160            | 600        | 1000        | 32             | 19.20                          | •             | 14           | €88.67                    |
| 124816       | Tissue faced (black)   | 130            | 600        | 1000        | 36             | 21.60                          | •             | 12           | €70.15                    |
| 239238       | Tissue faced (black)   | 160            | 600        | 1000        | 32             | 19.20                          | •             | 14           | €88.33                    |
| 124822       | Tissue faced (white)   | 130            | 600        | 1000        | 36             | 21.60                          | •             | 12           | €70.15                    |

## High-Impact Soffit Slab

Pallet size 2400 x 1200mm

| Product Code | Additional Information | Thickness (mm) | Width (mm) | Length (mm) | Pieces/ Pallet | Area/ Pallet (m <sup>2</sup> ) | Made to Order | MOQ (Pallet) | List Price/m <sup>2</sup> |
|--------------|------------------------|----------------|------------|-------------|----------------|--------------------------------|---------------|--------------|---------------------------|
| 255151       | 6mm High impact facing | 136            | 600        | 1200        | 32             | 23.04                          | •             | 1            | €150.43                   |
| 129544       | 6mm High impact facing | 166            | 600        | 1200        | 24             | 17.28                          | •             | 1            | €171.99                   |

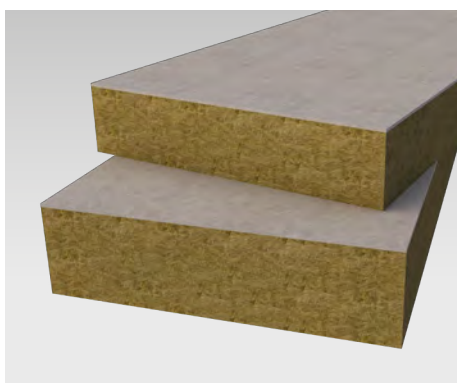

Soffit Slab - High Impact orders cannot be used to contribute towards mixed loads. The lead times for these products can vary and will be confirmed on receipt of order. Contact Customer Services for more information.

# Fire Stopping Solutions

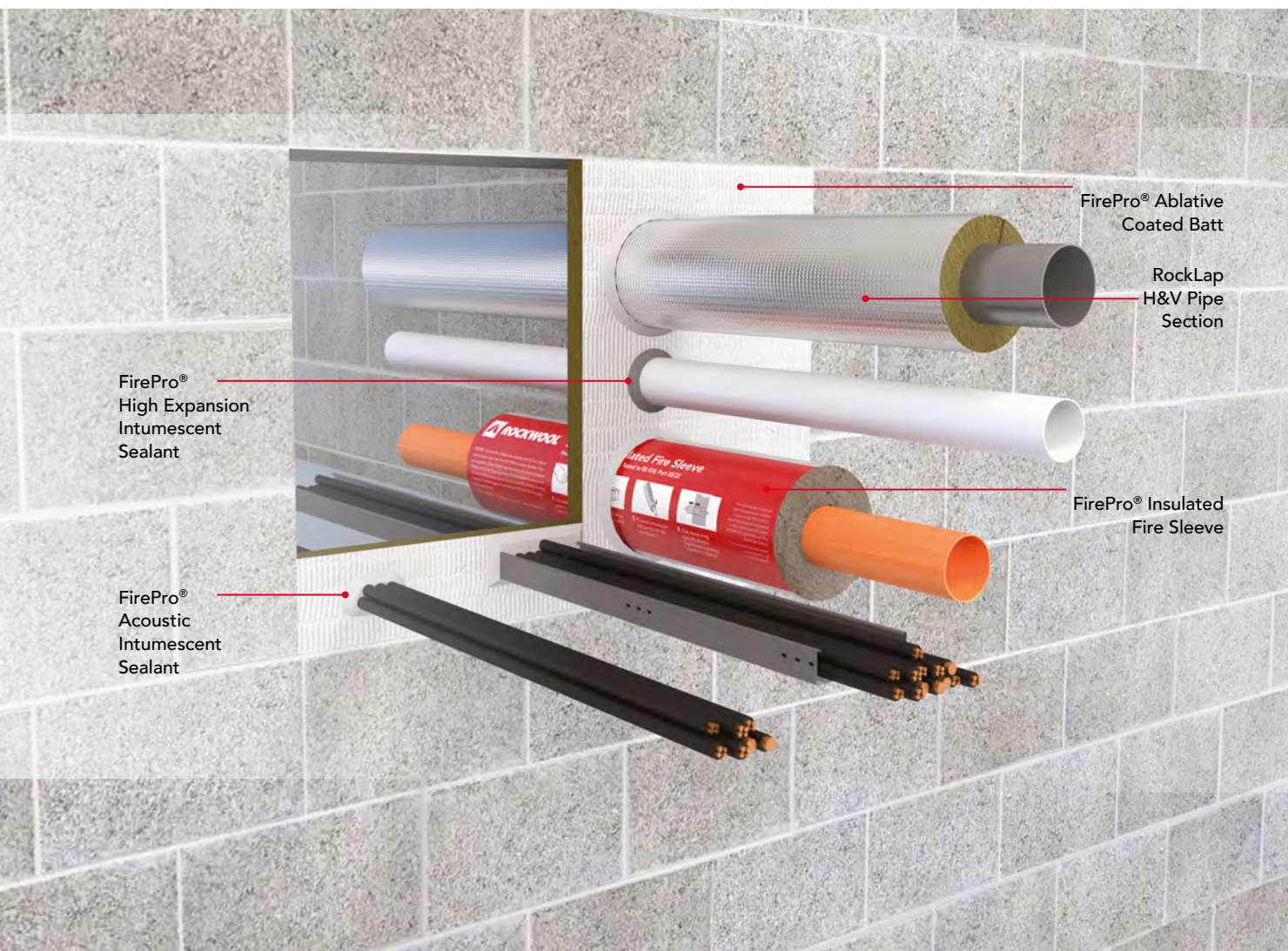

**Fire Stopping solutions ensure that the fire resistance of protected walls, floors and roofs are never compromised by services or voids.**

To stop fire spreading, UK Building Regulations insist on effective compartmentation, where fire, smoke and gases must be kept for as long as possible where they have originated. Our range of firestopping products ensure that cables, pipes, trunking, or ductwork, or the voids that they pass through, don't provide the weak link through which fire can spread.

Our comprehensive range of Penetration seals, Cavity barriers, Cavity fire stops and linear joint seals are listed in this section and suitable for most applications. However, if your requirement is a little out of the ordinary, contact your local ROCKWOOL representative, you can get their details at: [www.rockwool.com/uk/contact-us/](http://www.rockwool.com/uk/contact-us/)



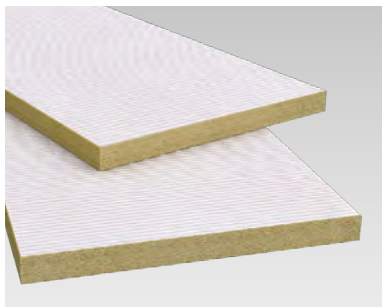

## FirePro® Ablative Coated Batt

Ablative Coated Batt acts as an air seal barrier to reinstate the fire resistance and acoustic performances of concrete floors, masonry walls and dry wall systems, following the creation of voids for the passage of services.

### Benefits:

- Up to 4 hours\* fire performance
- No maintenance required
- Lightweight and simple to install
- Tested for airtightness

*\*Subject to the application.*

Pallet size 1200 x 1200mm

| Product Code | Thickness (mm) | Width (mm) | Length (mm) | Pieces/ Pallet | Area/ Pallet (m <sup>2</sup> ) | List Price/ Batt |
|--------------|----------------|------------|-------------|----------------|--------------------------------|------------------|
| 123094       | 50             | 600        | 1200        | 48             | 34.56                          | €27.52           |
| 123096       | 60             | 600        | 1200        | 40             | 28.80                          | €29.77           |



## FirePro® Ablative Liquid

Ablative Coating is used to further improve the fire resistant properties of ROCKWOOL stone wool slabs. The ablative nature of the coating resists the risk of flame spreading and forms an insulated char which protects the stone wool slab. Ablative Coating is used within the manufacturing process of the ROCKWOOL Ablative Coated Batts and is available separately to enable any site repairs.

| Product Code | Additional Information | Tub Size (Litre) | Unit | MOQ (Tub) | List Price/ Tub |
|--------------|------------------------|------------------|------|-----------|-----------------|
| 128085       | Ablative Liquid        | 5                | Tub  | 1         | €54.50          |

*For coverage details, please refer to our Technical Data Sheet.*



## FirePro® Acoustic Intumescent Sealant

Acoustic Intumescent Sealant seals joints and service penetrations within walls, partitions, fire rated door frames and glazing systems. It can also be used to seal joints within party walls to provide an acoustic seal.

Tested to BS EN 1366-4 as a linear fire-stop and to BS EN 1366-3 within penetration seals.

### Benefits:

- Up to 4 hours\* fire performance
- No maintenance required
- Lightweight and simple to install
- Tested for airtightness

*\*Subject to the application.*

Pallet size 1200 x 1200mm

| Product Code | Additional Information | Cartridge Size (ml) | Tub Size (kg) | Unit    | Units/ Box | Boxes/ Pallet | MOQ   | Unit List Price |
|--------------|------------------------|---------------------|---------------|---------|------------|---------------|-------|-----------------|
| 212902       | Sealant                | 310                 |               | Box     | 25         | 64            | 1 Box | €92.33/Box      |
| 241969       | Sealant                | 600                 |               | Sausage | 12         | 65            | 1 Box | €99.26/Box      |
| 128091       | Trowel Grade           |                     | 5             | Tub     |            | 54*           | 1 Tub | €71.23/Tub      |

*\*The figure quoted is for units/tubs per pallet. For coverage details, please refer to our Technical Data Sheet.*



Ablative Coated Batt will be shipped as part of full loads and subject to the delivery conditions detailed on pages 7 and 8. All other ROCKWOOL Fire Stopping products are dispatched via a courier and not shipped as part of full loads, as such these products will incur a carriage charge. For further details please contact ROCKWOOL Customer Support Centre.

# ROCKWOOL SCB



**Select and install ROCKWOOL cavity barriers from a streamlined, EN-tested range.**

Fitted under compression, SCB inhibits the passage of fire and smoke within masonry, timber and steel frame constructions.

- Tested to BS EN 1366-4:2021
- 110mm and 200mm widths, suitable for cavities up to 290mm
- Supports in reducing air leakage and heat loss
- Horizontal and vertical applications
- Fire rating up to E120, I45 subject to the application



[< Back to Contents Page](#)



**Find out more:**



[rockwool.com/uk/SCB](https://rockwool.com/uk/SCB)



[rockwool.com/uk](https://rockwool.com/uk)

T: 00 44 1656 868 400



## FirePro® Silicone X

Supplied in 310ml cartridges, FirePro® Silicone X is a fire resistance silicone sealant designed for use as a linear joint seal within construction joints of walls and floors. Silicone X is white in colour and suitable for construction joints of up to 60mm.

### Benefits:

- Suitable for internal and external use
- Can provide a cold smoke seal
- Tested with multiple substrates
- Cartridges contain 30% recycled plastic

| Product Code | Additional Information | Cartridge Size (ml) | Cartridges/ Box | MOQ (Box) | List Price/ Cartridge |
|--------------|------------------------|---------------------|-----------------|-----------|-----------------------|
| 322075       | White                  | 310                 | 25              | 1         | €21.49                |

For coverage details, please refer to our Technical Data Sheet.



## FirePro® FireStop Compound

FireStop Compound provides a fire resisting seal around service penetrations within fire rated walls and floors. Tested to BS476:Part 20 1987, FireStop Compound provides up to 6 hours\* fire protection.

### Benefits:

- Provides up to 6 hours\* fire protection
- No smoke emission
- No maintenance required
- Load bearing

\*Subject to the application.

| Product Code | Bag Size (kg) | MOQ (Bag) | List Price/ Bag |
|--------------|---------------|-----------|-----------------|
| 128059       | 22            | 1         | €75.84          |

For coverage details, please refer to our Technical Data Sheet.



## FirePro® High Strength FireStop Compound

ROCKWOOL FirePro® HS FireStop Compound is designed to provide a fire-resisting seal around service penetrations in both fire rated wall and floor applications.

Tested to BS EN 1366:Part 3 HS FireStop compound provides up to 4 hours\* fire resistance.

### Benefits:

- High load-bearing capacity
- Suitable with multiple service penetrations
- Can be formed into blocks
- Effective smoke and acoustic barrier

\*Subject to the application.

| Product Code | Bag Size (kg) | Bags/ Pallet | MOQ (Pallet) | List Price/ Bag |
|--------------|---------------|--------------|--------------|-----------------|
| 260505       | 20            | 50           | 1            | €116.11         |



Many of the products available from the FirePro® range are dispatched via a courier and therefore not shipped as part of a full or mixed load, as such, these products may incur additional carriage charges. For further details please contact the ROCKWOOL Customer Support Centre.





## FirePro® High Expansion Intumescent Sealant

High Expansion Intumescent Sealant is an easy to apply water-based acrylic emulsion sealant containing graphite. It expands at temperatures above 135°C sealing around various penetrations and services to prevent the passage of smoke and flames.

### Benefits:

- Flexible and durable
- Used on combustible and non-combustible pipes
- Up to 4 hours\* fire protection
- Suitable for cables (single cables or bunches of cables)

*\*Subject to the application.*

| Product Code | Additional Information | Cartridge Size (ml) | Cartridges/ Box | MOQ (Box) | List Price/ Cartridge |
|--------------|------------------------|---------------------|-----------------|-----------|-----------------------|
| 128086       | Grey                   | 310                 | 25              | 1         | €31.68                |

For coverage details, please refer to our Technical Data Sheet.

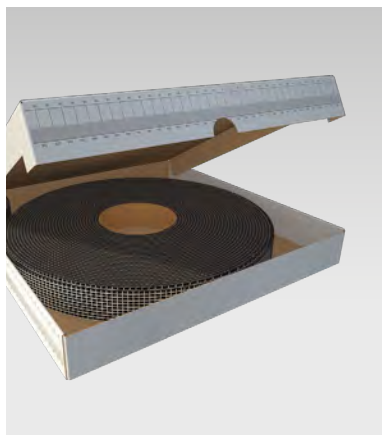

## FirePro® Intumescent Pipewrap Roll

FirePro® Intumescent Pipewrap Roll offers a simple and more economical alternative to FireStop Collars and avoids the need to carry a wide range of individually sized Intumescent pipe wraps. Intumescent Pipewrap Roll is suitable for firestopping a variety of combustible pipes and metallic pipes insulated with combustible insulation in both walls and floors.

### Benefits:

- Simple to Install
- No mechanical fixings required
- Water resistant
- Maintenance-free
- Supplied as a 25m long roll in box dispenser
- Available to suit pipes up to 200mm O/D
- Comprehensively tested
- Available from stock

| Product Code | Roll Size (m) | Rolls/ Box | MOQ (Box) | List Price/ Box |
|--------------|---------------|------------|-----------|-----------------|
| 234505       | 25            | 1          | 1         | €633.68         |



## FirePro® SpeedSeal

FirePro® SpeedSeal is a putty-based penetration sealing device for small cables and conduits in flexible and rigid walls. Available in 60mm and 100mm diameter disc's, tested to EN 1366-3.

### Benefits:

- Easy & Quick to Install
- Up to EI 60 fire resistance
- 2 different size combinations to cover most small openings

| Product Code | To Suit Service Opening | Diameter (mm) | Fire Rating (Hours) | Pieces/ Box | MOQ (Box) | List Price/ Box |
|--------------|-------------------------|---------------|---------------------|-------------|-----------|-----------------|
| 299522       | 25mm x 25mm             | 60            | 1                   | 20          | 1         | €95.76          |
| 299526       | 50mm x 50mm             | 100           | 1                   | 20          | 1         | €124.29         |



## FirePro® Insulated Fire Sleeves

Insulated Fire Sleeves are made up of a unique combination of stone wool and graphite intumescent; as a result they provide both thermal and fire insulation.

When exposed to fire they expand sealing gaps between the sleeve and the surrounding construction/pipework.

### Benefits:

- Provides up to 2 hours\* fire resistance
- Maintains pipe insulation at penetration points
- Supplied with integral vapour barrier
- No mastic or ancillaries required
- Excellent thermal and acoustic insulation

\*Subject to the application.

Length 300mm

| Product Code | Nominal O/D (mm) | Thickness (mm) | Made to Order | MOQ (Each) | List Price/ Each |
|--------------|------------------|----------------|---------------|------------|------------------|
| 128109       | 17               | 25             | •             | 1          | €97.58           |
| 128110       | 21               | 25             | •             | 1          | €100.95          |
| 128101       | 27               | 25             | •             | 1          | €110.86          |
| 128102       | 34               | 25             | •             | 1          | €112.36          |
| 128103       | 42               | 25             | •             | 1          | €119.73          |
| 128111       | 48               | 25             | •             | 1          | €120.81          |
| 128112       | 54               | 25             | •             | 1          | €123.73          |
| 128113       | 60               | 25             | •             | 1          | €127.24          |
| 128114       | 67               | 25             | •             | 1          | €130.95          |
| 128115       | 76               | 25             | •             | 1          | €136.49          |
| 128105       | 80               | 25             | •             | 1          | €140.66          |
| 128106       | 89               | 25             | •             | 1          | €155.36          |
| 128116       | 102              | 25             | •             | 1          | €162.25          |
| 128107       | 108              | 25             | •             | 1          | €166.76          |
| 128108       | 114              | 25             | •             | 1          | €177.88          |
| 128117       | 127              | 25             | •             | 1          | €190.11          |
| 128118       | 140              | 25             | •             | 1          | €199.30          |
| 128119       | 160              | 25             | •             | 1          | €221.98          |
| 128120       | 169              | 25             | •             | 1          | €224.76          |

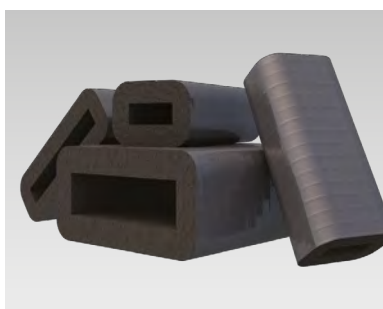

## FirePro® Insulated Fire Duct Sleeve

Insulated Fire Sleeves to be cut to length to suit penetration (minimum length 60mm). Other sizes are available.

Length 180mm

| Product Code | Width (mm) | Height (mm) | Made to Order | MOQ (Each) | List Price/ Each |
|--------------|------------|-------------|---------------|------------|------------------|
| 223687       | 110        | 54          | •             | 1          | €94.66           |
| 223688       | 204        | 60          | •             | 1          | €126.06          |
| 294019       | 220        | 90          | •             | 1          | €189.09          |



Many of the products available from the FirePro® range are dispatched via a courier and therefore not shipped as part of a full or mixed load, as such, these products may incur additional carriage charges. For further details please contact the ROCKWOOL Customer Support Centre.

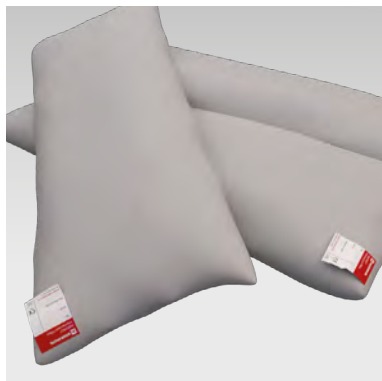

## FirePro® Intumescent Pillow CE

FirePro® Intumescent Pillows CE are available in various sizes for packing into void spaces around services. Simple to install they are an ideal solution when installing additional services as they are easy to remove and reinstate.

Intumescent Pillows CE can be installed within rigid wall and rigid floor constructions. Intumescent Pillows CE are designed to create a temporary or permanent fire seal around services to maintain continuity of fire performance of compartment walls and floors.

### Benefits:

- High performance intumescent
- Up to EI120\* fire resistance
- Easy to install, remove and reinstate
- Suitable for flexible wall and rigid wall/floor constructions
- Maintenance free
- Dry system

*\*Subject to the application.*

| Product Code | Thickness (mm) | Width (mm) | Length (mm) | MOQ (Pillow) | List Price/ Pillow |
|--------------|----------------|------------|-------------|--------------|--------------------|
| 301310       | 20             | 50         | 330         | 1            | €21.98             |
| 301311       | 25             | 200        | 330         | 1            | €29.97             |
| 301313       | 45             | 200        | 330         | 1            | €34.18             |



## FirePro® Intumescent Putty Pads

Intumescent Putty Pads have been developed for use in plasterboard partitions that have been partially penetrated by electrical socket boxes. They have been designed to maintain acoustic integrity and fire resistance.

Available for internal and external sockets in single and double gang boxes.

### Benefits:

- Pre-cut cross shape ensures simple and easy installation
- Low smoke emission
- Internal Putty Pads reduce noise transfer
- Remains malleable

| Product Code | Additional Information | Pad/ Box | MOQ (Each) | List Price/ Each |
|--------------|------------------------|----------|------------|------------------|
| 128092       | Internal Single        | 20       | 1          | €14.79           |
| 128093       | Internal Double        | 20       | 1          | €21.33           |





## FirePro® Intumescent Pipe Wrap CE

FirePro® Intumescent Pipe Wraps CE are supplied in lengths to suit various pipe diameters designed to protect both plastic pipework and electrical trunking in fire rated walls and floors, making them a highly adaptable product for many construction projects.

Manufactured from layers of a graphite-based intumescent sheet encased in a polythene sheath, this design is able to fit most trunking sizes with the product wrapped around the outside of the pipework and fixed in places with self-adhesive strips.

### Benefits:

- High performance intumescent
- Up to EI120\* fire resistance
- Easy to install
- Tested in conjunction with Ablative Coated Batt seals
- Maintenance free
- Dry system

*\*Subject to the application.*

| Product Code | Nominal O/D (mm) | MOQ (Each) | List Price/ Each |
|--------------|------------------|------------|------------------|
| 302323       | 40mm             | 1          | €9.23            |
| 302326       | 55mm             | 1          | €12.11           |
| 302327       | 63mm             | 1          | €13.00           |
| 302328       | 75mm             | 1          | €14.40           |
| 302329       | 82mm             | 1          | €18.08           |
| 302330       | 90mm             | 1          | €19.29           |
| 302331       | 110mm            | 1          | €22.16           |
| 302332       | 125mm            | 1          | €29.86           |
| 302333       | 160mm            | 1          | €53.63           |
| 302334       | 200mm            | 1          | €67.04           |



Many of the products available from the FirePro® range are dispatched via a courier and therefore not shipped as part of a full or mixed load, as such, these products may incur additional carriage charges. For further details please contact the ROCKWOOL Customer Support Centre.



## FirePro® Pipe Collar CE

FirePro® CE Pipe Collars are tested in accordance with BS EN 1366-3: 2009 to provide up to EI120\* in walls and EI240\* in rigid floors.

They are designed to seal service penetrations in apertures in walls and floors containing plastic pipes.

### Benefits:

- Easy fixing method using common fixings
- Tested in rigid/flexible walls and rigid floors
- Up to 4 hours\* fire resistance

*\*Subject to the application.*

| Product Code | Fire Rating (Hours) | Nominal O/D (mm) | MOQ (Box) | List Price/ Each |
|--------------|---------------------|------------------|-----------|------------------|
| 294131       | 2                   | 40               | 1         | €24.83           |
| 294136       | 2                   | 55               | 1         | €29.85           |
| 294137       | 2                   | 63               | 1         | €31.04           |
| 294138       | 2                   | 75               | 1         | €43.43           |
| 294139       | 2                   | 82               | 1         | €44.97           |
| 294140       | 2                   | 90               | 1         | €53.25           |
| 294142       | 2                   | 110              | 1         | €62.41           |
| 294143       | 2                   | 125              | 1         | €82.95           |
| 294145       | 2                   | 160              | 1         | €147.64          |
| 294147       | 2                   | 200              | 1         | €215.83          |
| 294149       | 2                   | 250              | 1         | €585.39          |



Many of the products available from the FirePro® range are dispatched via a courier and therefore not shipped as part of a full or mixed load, as such, these products may incur additional carriage charges. For further details please contact the ROCKWOOL Customer Support Centre.

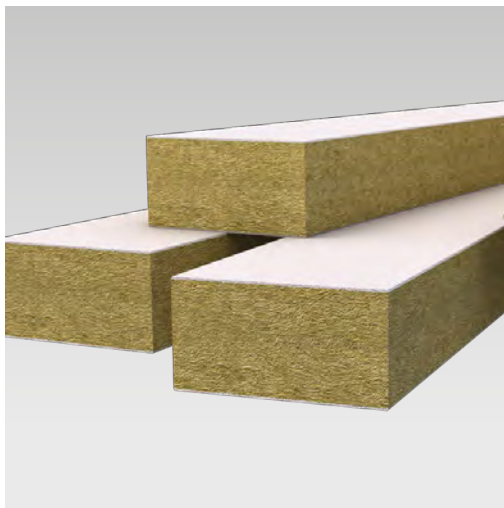

## FirePro® SoftSeal System

FirePro® SoftSeal provides a firestopping solution for applications where high levels of movement in the building's services or joints need to be accommodated.

SoftSeal Linear Joint Seal is specifically designed to form a linear joint seal within buildings, where the design needs to accommodate movement in the joint. The product is only coated on one side.

### Benefits:

- Acoustically absorbent
- Up to 2 hours\* fire protection
- UL EU Certified
- Both vertical and horizontal joint applications

*\*Subject to the application.*

## FirePro® SoftSeal

| Product Code | Additional Information            | Thickness (mm) | Width (mm) | Length (mm) | Pieces/ Pallet | Area/ Pallet (m²) | Made to Order | MOQ (Pallet) | List Price Per Piece |
|--------------|-----------------------------------|----------------|------------|-------------|----------------|-------------------|---------------|--------------|----------------------|
| 289903       | Linear Joint Seal - Coated 1 Side | 100            | 200        | 1200        | 72             | 17.28             | •             | 1            | €59.71               |
| 289908       | Coated Strip - Coated 2 Sides     | 100            | 200        | 1200        | 72             | 17.28             | •             | 1            | €64.93               |

## FirePro® SoftSeal Ancillaries

| Product Code | Additional Information | Pack Size | Pack | Made to Order | MOQ   | Unit List Price |
|--------------|------------------------|-----------|------|---------------|-------|-----------------|
| 190377       | Flexible Coating       | 5ltr      | Tub  |               | 1 Tub | € 224.59        |





# Be in the know on passive **fire protection**



Our latest fire CPDs will help you advise on product choices and applications with confidence:

## **Fire Stopping: Understanding your liability**

This CPD will provide insight into how you can fulfil your legal responsibilities through improved knowledge and adopting best practices.

## **A to Z of Essential Principles**

The A to Z of Essential Principles are of vital importance and should be considered in detail by building designers, fire engineers, consultants, occupiers or building owners.

## **Passive Fire Protection for Structural Steel**

This CPD focuses on providing an understanding of the key considerations for insulating structural steel members, and how choosing the right insulation solutions can extend fire protection periods and simplify compliance.

Book your free sessions now at [www.rockwool.com/uk/cpd](http://www.rockwool.com/uk/cpd)





# HVAC Products

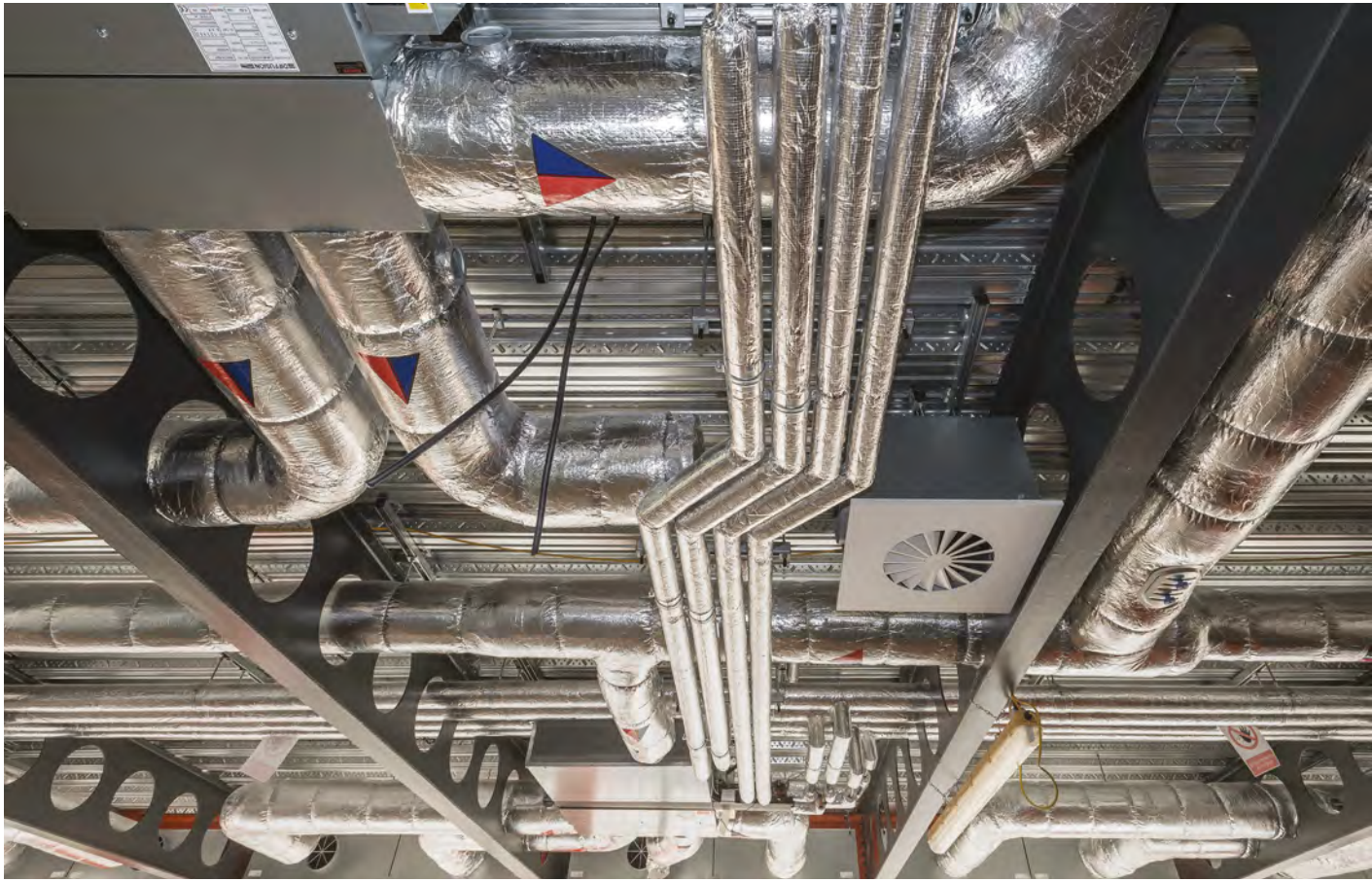

Heating Ventilation and Air conditioning (HVAC) systems form an integral part of modern environments, both commercial and domestic - particularly where high rise and large scale developments are concerned.

ROCKWOOL non-combustible stone wool products for HVAC applications can be used to control heat gain, minimise heat loss and reduce noise. In addition, certain products can deliver a fire resistance rating both into, and out of, the HVAC system.

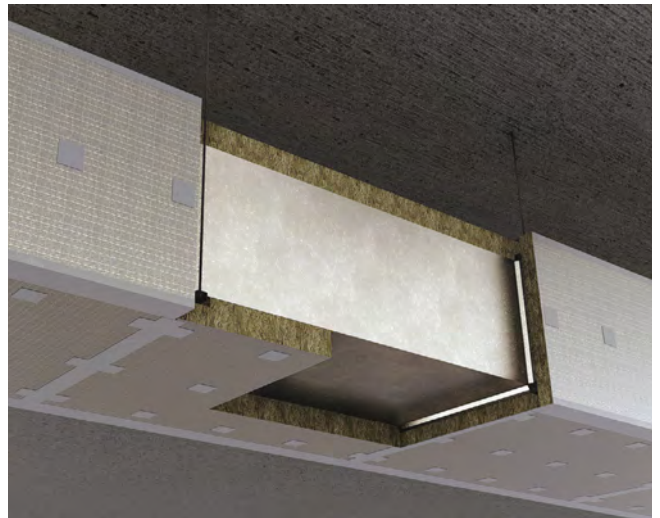

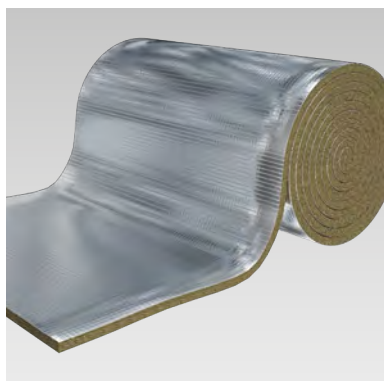

## DuctSlab and DuctWrap

DuctSlab and DuctWrap provide thermal insulation for air conditioning, warm air and extractor ducts, located either in plant rooms and boiler houses or externally. They can also be used to thermally insulate cold water storage tanks, feeds and expansion tanks with service temperatures of up to 230°C.

DuctWrap consists of a lightweight, flexible insulation roll faced with reinforced aluminium foil. DuctSlab consists of a semi-rigid insulation slab faced with reinforced aluminium foil.

### Benefits:

- CE marked to EN14303
- Non-combustible (Euroclass A1)
- Water repellent
- Chemically inert
- Easy to handle and install

*Alternative thicknesses can be made to order.*

*For details please contact your local ROCKWOOL representative.*

Pallet size 1200 x 1200mm

| Product Code | Additional Information | Thickness (mm) | Width (mm) | Length (mm) | Pieces/ Pack | Area/ Pack (m²) | Packs/ Pallet | Area/ Pallet (m²) | List Price/m² |
|--------------|------------------------|----------------|------------|-------------|--------------|-----------------|---------------|-------------------|---------------|
| 122929       | Slab                   | 40             | 600        | 1000        | 10           | 6.00            | 15            | 90.00             | €20.97        |
| 122930       | Slab                   | 50             | 600        | 1000        | 8            | 4.80            | 15            | 72.00             | €24.86        |
| 122931       | Wrap                   | 25             | 1000       | 5000        | 2            | 10.00           | 21            | 210.00            | €16.71        |
| 122932       | Wrap                   | 40             | 1000       | 4000        | 2            | 8.00            | 21            | 168.00            | €21.41        |
| 361674       | Wrap                   | 50             | 1000       | 5000        | 1            | 6.00            | 21            | 126.00            | €24.71        |

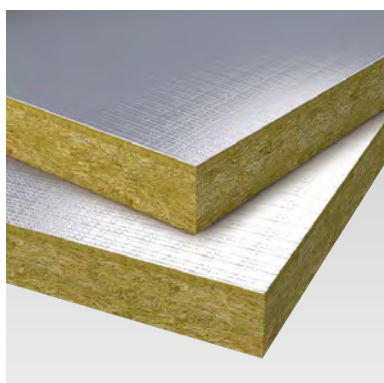

## DuoDuct External DuctSlab

DuoDuct is a Dual-Density stone wool slab with an aluminium foil facing bonded to the outer surface. The robust outer layer provides enhanced impact resistance and a suitable substrate for surface applications such as cladding.

Designed for use on rectangular or square external ductwork, ROCKWOOL DuoDuct is suitable for insulating cold air, hot air and dual-purpose duct systems – withstanding service temperatures of up to 230°C.

### Benefits:

- Rated Euroclass A1 non-combustible
- Suitable for use with self-adhered external duct membranes
- For increased efficiency, the slabs are designed to be easy to cut and install
- ROCKWOOL Dual-Density technology provides enhanced impact resistance, ideal for areas susceptible to damage
- Sound absorbent qualities to reduce environmental noise

*Alternative thicknesses can be made to order.*

*For details please contact your local ROCKWOOL representative.*

Pallet size 2000 x 1200mm

| Product Code | Additional Information | Thickness (mm) | Width (mm) | Length (mm) | Pieces/Pallet | Area/ Pallet (m²) | MOQ (Pallet) | List Price/m² |
|--------------|------------------------|----------------|------------|-------------|---------------|-------------------|--------------|---------------|
| 263218       | Foil faced             | 50             | 1200       | 2000        | 24            | 57.60             | 1            | €27.62        |



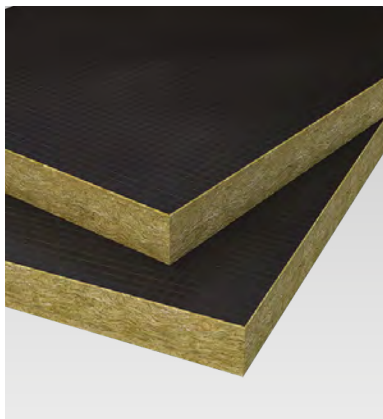

## DuctRock® Slab

Tested to BS EN 1366:Part 1 and BS EN 1366:Part 8, DuctRock® Slab is capable of providing up to 2 hours\* fire ratings on both ventilation and smoke extract ducts. The new high emissivity black foil provides a great aesthetic finish and clearly identifies the product as the latest EN tested solution. Quick to install and easy to handle, DuctRock® Slab achieves fire ratings ranging from EI30 to EI120 with only 3 thicknesses.

### Benefits:

- Up to 2 hours\* fire rating in accordance with EN 1366:Part 1 and EN 1366:Part 8
- Black foil finish
- Suitable with many duct types
- Patented dry wall penetration detail
- Quick and easy to install

*\*Subject to the application.*

Pallet Size 2000 x 1200mm

| Product Code | Additional Information | Thickness (mm) | Width (mm) | Length (mm) | Pieces/Pallet | Area/Pallet (m <sup>2</sup> ) | Made to Order | MOQ (Pallet) | List Price/m <sup>2</sup> |
|--------------|------------------------|----------------|------------|-------------|---------------|-------------------------------|---------------|--------------|---------------------------|
| 262503       | Black foil facing      | 60             | 1000       | 1200        | 42            | 50.40                         |               |              | €138.45                   |
| 262505       | Black foil facing      | 80             | 1000       | 1200        | 32            | 38.40                         | •             | 8            | €227.22                   |
| 262507       | Black foil facing      | 90             | 1000       | 1200        | 24            | 28.80                         |               |              | €255.79                   |

| Product Code | Additional Information | Thickness (mm) | Width (mm) | Length (m) | Rolls/Box | MOQ (Box) | List Price/Roll |
|--------------|------------------------|----------------|------------|------------|-----------|-----------|-----------------|
| 259345       | Black ALU foil tape    | N/A            | 75         | 50         | 16        | 1         | €61.76          |

| Product Code | Additional Information | Thickness (mm) | Width (mm) | Length (mm) | Pieces/Pack | MOQ (Pack) | List Price/Pack |
|--------------|------------------------|----------------|------------|-------------|-------------|------------|-----------------|
| 273113       | Steel U-Profile        | 1.5            | 60         | 1500        | 4           | 1          | €117.73         |

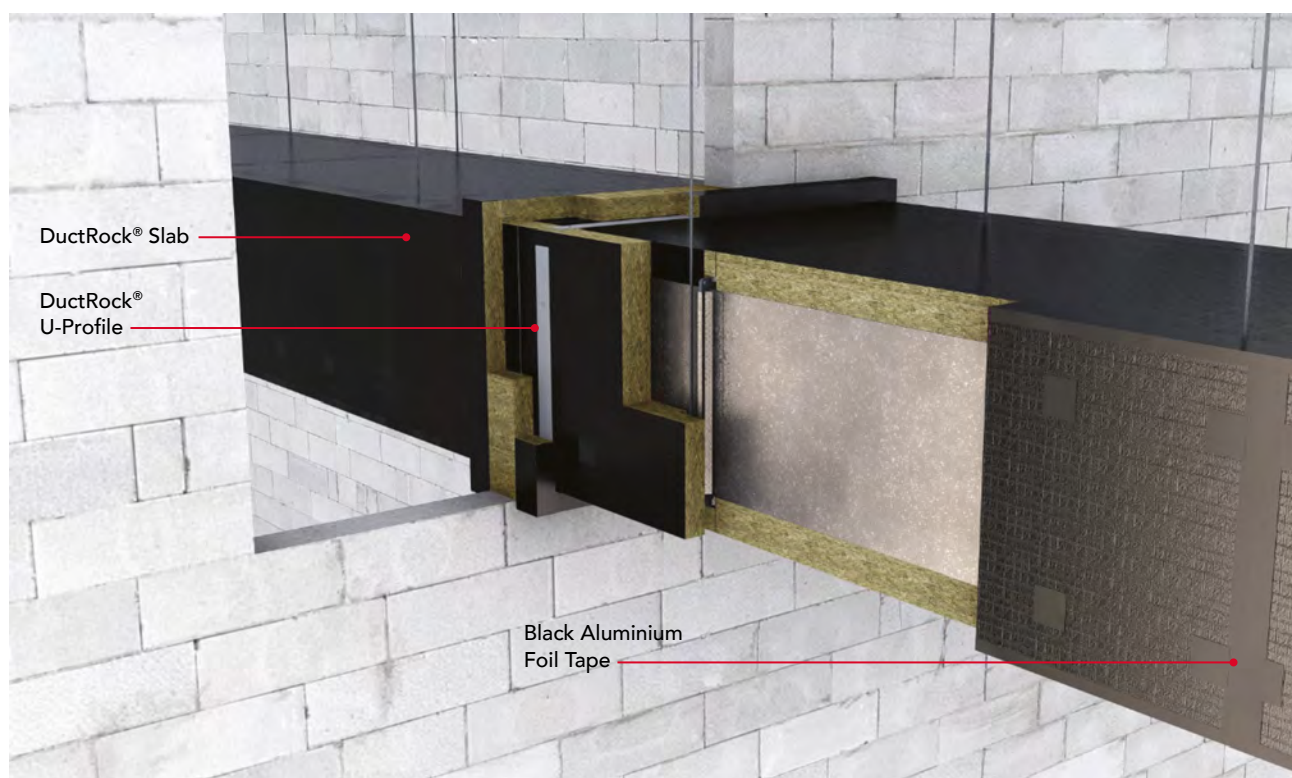

# Achieve CO<sub>2</sub> savings with BS 5422:2023

The Guide to BS 5422:2023 clarifies recent changes to the technical document for thermal insulation of building services.

Download the comprehensive ROCKWOOL handbook to BS 5422:2023 featuring:

- An accessible changelog
- Updated thickness tables per application
- Insulation best practice
- Recommended ROCKWOOL solutions

**Start specifying today and ensure best practice for building services insulation.**



**Download the guide:**



[rockwool.com/uk/  
building-services-hvac-hub](https://rockwool.com/uk/building-services-hvac-hub)



[X](#) [in](#) [f](#) [@](#) [v](#)  
[rockwool.com/uk](https://rockwool.com/uk)



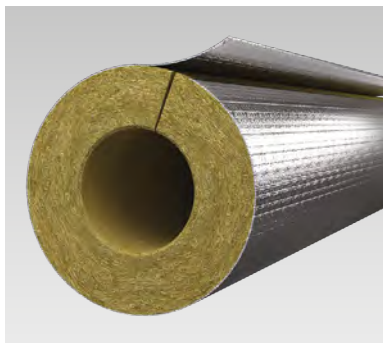

## RockLap H&V Pipe Sections

RockLap H&V Pipe Sections are strong lengths of pre-formed insulation with a one piece, factory applied foil facing with integral self-adhesive lap. The integral lap ensures fast and easy installation: just snap the sections onto the pipe, peel off the backing tape and smooth down for a completely sealed joint.

Please contact ROCKWOOL Customer Support Centre for further information. Alternatives Sizes may be available. For further details please contact your ROCKWOOL Sales Representative. These products are POA, subject to availability and MOQ at the time of enquiry.

**ALL PRODUCTS LISTED ARE MADE TO ORDER.**

|                               | List Price/linear metre by thickness |            |    |                 |            |    |                 |            |    |                 |            |    |                 |            |   |  |
|-------------------------------|--------------------------------------|------------|----|-----------------|------------|----|-----------------|------------|----|-----------------|------------|----|-----------------|------------|---|--|
| To Suit<br>Pipe O/D<br>per mm | 20mm                                 |            |    | 25mm            |            |    | 30mm            |            |    | 40mm            |            |    | 50mm            |            |   |  |
|                               | Product<br>Code                      | List Price |    | Product<br>Code | List Price |    | Product<br>Code | List Price |    | Product<br>Code | List Price |    | Product<br>Code | List Price |   |  |
| 17                            | 225617                               | €8.80      | 42 | 225619          | €9.78      | 30 | 225620          | €12.80     | 25 | TBC             | €18.13     | 16 |                 |            |   |  |
| 21                            | 225621                               | €9.24      | 36 | 225622          | €10.32     | 30 | 225625          | €13.61     | 20 | 295306          | €17.18     | 13 | TBC             | €24.51     | 9 |  |
| 27                            | 225626                               | €9.77      | 30 | 225628          | €11.68     | 25 | 225629          | €14.61     | 20 | 295307          | €19.41     | 12 | 361452          | €25.49     | 9 |  |
| 34                            | 292265                               | €10.67     | 25 | 292266          | €12.35     | 20 | 292267          | €15.29     | 16 | 292268          | €19.46     | 9  | 292269          | €27.40     | 8 |  |
| 42                            | 252816                               | €11.99     | 20 | 253323          | €13.56     | 16 | 253324          | €16.71     | 12 | 295310          | €20.62     | 9  | 295312          | €28.62     | 6 |  |
| 48                            | 253613                               | €12.80     | 16 | 253614          | €14.61     | 16 | 253616          | €17.70     | 12 | 295297          | €21.66     | 9  | 295305          | €30.13     | 6 |  |
| 54                            | 253618                               | €13.81     | 16 | 253619          | €15.72     | 12 | 253622          | €19.19     | 10 | 295298          | €23.54     | 8  | 295303          | €32.14     | 5 |  |
| 60                            | 253624                               | €14.63     | 12 | 253625          | €16.71     | 12 | 253627          | €20.44     | 9  | 295299          | €25.06     | 7  | 295301          | €34.13     | 5 |  |
| 67                            |                                      |            |    | TBC             | €24.81     | 9  |                 | €25.85     | 9  | TBC             | €30.88     | 6  | TBC             | €36.16     | 4 |  |
| 76                            |                                      |            |    | TBC             | €25.25     | 9  |                 | €27.00     | 7  | TBC             | €31.41     | 5  | TBC             | €40.89     | 4 |  |
| 89                            |                                      |            |    | TBC             | €27.36     | 6  |                 | €29.16     | 6  | TBC             | €34.15     | 4  | 361400          | €40.40     | ■ |  |
| 102                           |                                      |            |    |                 |            |    |                 |            |    | TBC             | €37.03     | ■  |                 |            |   |  |
| 108                           |                                      |            |    | TBC             | €30.07     | 5  | TBC             | €31.81     | ■  | TBC             | €38.23     | ■  | TBC             | €50.13     | ■ |  |
| 114                           |                                      |            |    | TBC             | €31.55     | 4  | TBC             | €33.63     | ■  | 361404          | €39.18     | ■  | 361405          | €51.04     | ■ |  |
| 127                           |                                      |            |    | TBC             | €47.80     | 4  | TBC             | €47.52     | ■  | TBC             | €60.47     | ■  | TBC             | €60.30     | ■ |  |
| 133                           |                                      |            |    |                 |            |    | 361524          | €47.97     | ■  |                 |            |    | TBC             | €73.87     | ■ |  |
| 140                           |                                      |            |    | TBC             | €32.45     | ■  | 361411          | €37.92     | ■  | 361431          | €44.68     | ■  | 361413          | €57.41     | ■ |  |
| 154                           |                                      |            |    |                 |            |    |                 |            |    |                 |            |    | TBC             | €160.49    | ■ |  |
| 159                           |                                      |            |    | TBC             | €58.86     | ■  | TBC             | €43.67     | ■  | TBC             | €49.78     | ■  | TBC             | €64.16     | ■ |  |
| 169                           |                                      |            |    | TBC             | €41.02     | ■  | 361517          | €44.68     | ■  | 361516          | €52.26     | ■  | 361414          | €66.52     | ■ |  |
| 194                           |                                      |            |    |                 |            |    |                 |            |    |                 |            |    | TBC             | €91.38     | ■ |  |
| 205                           |                                      |            |    |                 |            |    |                 |            |    | TBC             | €85.95     | ■  | TBC             | €82.54     | ■ |  |
| 219                           |                                      |            |    | TBC             | €50.76     | ■  | TBC             | €57.81     | ■  | TBC             | €65.50     | ■  | 361415          | €83.60     | ■ |  |
| 253                           |                                      |            |    |                 |            |    |                 |            |    | TBC             | €181.02    | ■  | TBC             | €192.38    | ■ |  |
| 273                           |                                      |            |    | TBC             | €172.26    | ■  | TBC             | €124.64    | ■  | TBC             | €132.46    | ■  | TBC             | €133.82    | ■ |  |
| 305                           |                                      |            |    |                 |            |    |                 |            |    | TBC             | €200.63    | ■  |                 |            |   |  |
| 324                           |                                      |            |    |                 |            |    | TBC             | €194.42    | ■  | TBC             | €202.76    | ■  | TBC             | €151.12    | ■ |  |
| 356                           |                                      |            |    |                 |            |    | TBC             | €197.06    | ■  | TBC             | €214.02    | ■  | TBC             | €158.54    | ■ |  |



Benefits:

- Fast and simple to install reducing costs and time on site
- Tape requirement reduced
- CE marked to EN14303

**KEY:** 42 Number of linear metres per carton.

- Unsplit sections packed as single lengths and shrink wrapped in polyethylene.

- Split sections packed as single lengths and shrink wrapped in polyethylene.

Length 1000mm

[illegible]

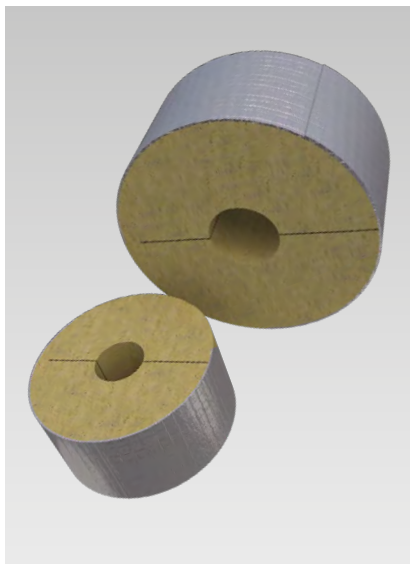

## RockLap H&V Pipe Supports

RockLap Pipe Supports are designed to reduce the thermal bridge at the point at which the pipe hanger clips are located. Pre-formed and pre-cut into cylindrical sections with a foil facing finish to maintain an integral vapour barrier. RockLap Pipe Supports are simple to install with a self-adhesive overlap. Combined with RockLap H&V Pipe section insulation solutions they provide a total thermal solution for pipework with the additional benefits of fire safety and acoustic comfort.

Please contact ROCKWOOL Customer Support Centre for further information. Alternative sizes may be available. For further details please contact your ROCKWOOL Sales Representative.

### ALL PRODUCTS LISTED ARE MADE TO ORDER.

Delivery terms are dependent upon order size:

- ≥40 cartons: Fixed delivery date, no surcharge.
- 15-39 cartons: €72 small order surcharge, fixed delivery date.
- Orders <15 cartons: €72 small order surcharge and subject to groupage within a 5 working day range (Mon - Fri).

| To Suit Pipe O/D (mm) | Length (mm) | 20mm         |              |                | 25mm         |              |                | 30mm         |              |                |
|-----------------------|-------------|--------------|--------------|----------------|--------------|--------------|----------------|--------------|--------------|----------------|
|                       |             | Product Code | Supports/Box | List Price/Box | Product Code | Supports/Box | List Price/Box | Product Code | Supports/Box | List Price/Box |
| 17                    | 80          | 287429       | 128          | €707.46        | 287437       | 98           | €579.54        | 290202       | 72           | €457.04        |
| 21                    | 80          | 287431       | 128          | €729.99        | 287434       | 72           | €440.13        | 290274       | 72           | €473.95        |
| 27                    | 80          | 287436       | 98           | €579.54        | 287438       | 72           | €444.37        | 287442       | 50           | €342.81        |
| 34                    | 80          | 287443       | 72           | €480.99        | 287440       | 50           | €358.47        | 290200       | 50           | €383.88        |
| 42                    | 80          | 294323       | 72           | €513.38        | 287444       | 50           | €383.88        | 290523       | 32           | €316.19        |
| 48                    | 80          | 306127       | 50           | €360.43        | 290204       | 50           | €532.58        | 298804       | 32           | €345.61        |
| 54                    | 80          | 298840       | 50           | €363.36        | 290205       | 32           | €345.61        | 290584       | 32           | €362.53        |
| 60                    | 80          | 306323       | 50           | €390.76        | 290209       | 32           | €356.26        | 294324       | 32           | €385.69        |
| 67                    | 80          |              |              |                | 290214       | 32           | €365.04        | 301328       | 18           | €253.17        |
| 76                    | 80          |              |              |                | 290210       | 18           | €215.84        | 299639       | 18           | €260.55        |
| 89                    | 80          |              |              |                | 290216       | 18           | €263.04        | 300027       | 18           | €310.57        |
| 108                   | 80          |              |              |                | 290217       | 18           | €350.73        | 293380       | 8            | €181.30        |
| 114                   | 80          |              |              |                | 290218       | 18           | €382.76        | 300197       | 8            | €194.47        |
| 140                   | 80          |              |              |                | TBC          | 8            | €198.21        | 309994       | 8            | €253.77        |
| 169                   | 100         |              |              |                | 312499       | 8            | €278.17        | 300024       | 8            | €340.77        |

## ROCK-EQ HVAC TOOL



## Benefits:

- Non-combustible stone wool
- Energy efficient - minimising thermal bridging
- Robust foil facing to maintain a vapour control
- High point load resistance and effective load bearing capability
- A total insulation solution when combined with RockLap H&V pipe sections



Orders for RockLap H&V Pipe Supports cannot be used to contribute towards mixed loads. The lead times for these products can vary and will be confirmed on receipt of order.

Pallet Size 1200mm x 1000mm

|  | To Suit Pipe O/D (mm) | Length (mm) | 35mm         |               |                 | 40mm         |               |                 | 50mm         |               |                 |
|--|-----------------------|-------------|--------------|---------------|-----------------|--------------|---------------|-----------------|--------------|---------------|-----------------|
|  |                       |             | Product Code | Supports/ Box | List Price/ Box | Product Code | Supports/ Box | List Price/ Box | Product Code | Supports/ Box | List Price/ Box |
|  | 17                    | 80          | 315475       | 50            | €385.32         | 295606       | 50            | €441.61         | 299927       | 32            | €380.07         |
|  | 21                    | 80          | 312932       | 50            | €457.65         | 287795       | 32            | €292.41         | 299928       | 32            | €390.07         |
|  | 27                    | 80          | 309866       | 50            | €472.69         | 287794       | 32            | €299.92         | 299929       | 18            | €226.42         |
|  | 34                    | 80          | 300833       | 32            | €354.34         | 287409       | 32            | €335.62         | 300174       | 18            | €250.02         |
|  | 42                    | 80          | 302746       | 32            | €389.22         | 287412       | 32            | €390.07         | 289092       | 18            | €289.80         |
|  | 48                    | 80          | 309870       | 32            | €399.44         | 287414       | 18            | €215.84         | TBC          | 18            | €277.50         |
|  | 54                    | 80          | 312933       | 32            | €394.63         | 290525       | 18            | €223.95         | 294561       | 18            | €285.58         |
|  | 60                    | 80          | 309871       | 18            | €237.77         | 287417       | 18            | €238.02         | 298725       | 18            | €303.19         |
|  | 67                    | 80          | TBC          | 18            | €283.77         | 290527       | 18            | €298.95         | 290526       | 8             | €173.16         |
|  | 76                    | 80          | 312934       | 18            | €293.92         | 287426       | 18            | €305.64         | TBC          | 8             | €182.07         |
|  | 89                    | 80          | TBC          | 18            | €320.63         | 287428       | 12            | €240.87         | 290585       | 8             | €202.11         |
|  | 108                   | 80          | TBC          | 10            | €226.08         | 305637       | 8             | €202.42         | 304193       | 8             | €249.06         |
|  | 114                   | 80          | TBC          | 10            | €240.17         | 287791       | 8             | €214.80         | 301329       | 8             | €264.09         |
|  | 140                   | 80          | TBC          | 10            | €314.58         | 287789       | 8             | €280.34         | 309993       | 8             | €339.69         |
|  | 169                   | 100         | TBC          | 8             | €357.74         | 304418       | 8             | €377.70         | 329593       | 4             | €451.55         |

Select the optimum thickness of building services and HVAC insulation quickly and easily with our online calculator, ROCK-EQ.

The online tool produces detailed, project-specific calculation reports and recommendations from the ROCKWOOL HVAC range in a matter of minutes.

Find it at:

[www.rockwool.com/uk/resources-and-tools/tools/](http://www.rockwool.com/uk/resources-and-tools/tools/)

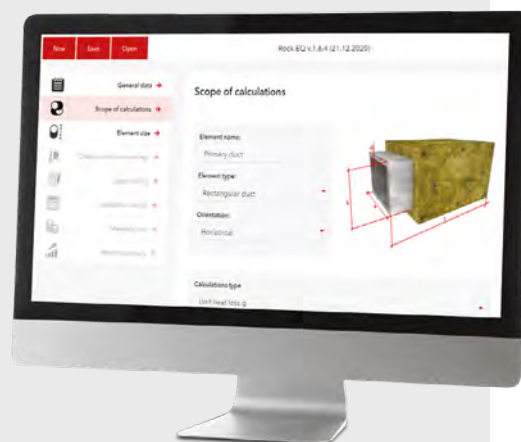



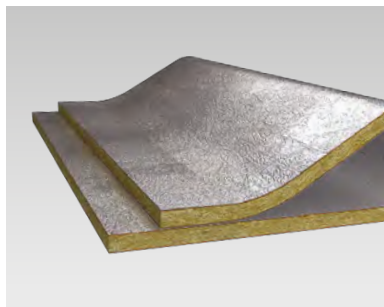

## Techwrap2

Made of ROCKWOOL stone wool insulation, acoustic membrane and a layer of reinforced aluminium foil, Techwrap2 is designed to enhance noise control to rectangular ductwork.

Techwrap2 has been independently tested at the Acoustical Investigation & Research Organisation (AIRO).

5kg/m<sup>2</sup> Polymeric. Pallet size 1200 x 1000mm

| Product Code | Additional Information | Thickness (mm) | Width (mm) | Length (mm) | Pieces/ Pallet | Made to Order | MOQ (Pallet) | List Price/m <sup>2</sup> |
|--------------|------------------------|----------------|------------|-------------|----------------|---------------|--------------|---------------------------|
| 251264       | Foil faced             | 25             | 1000       | 1200        | 40             | •             | 1            | €165.10                   |
| 251431       | Foil faced             | 50             | 1000       | 1200        | 20             | •             | 1            | €189.83                   |

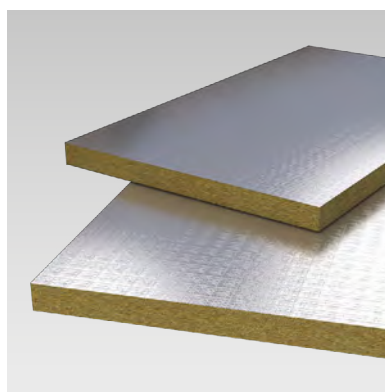

## Fire Duct Slab

Fire Duct Slab is designed for use within a square or rectangular third-party tested fire-rated ductwork system.

Please contact a third-party system holder for performance, certification and installation details.

Pallet Size 2000 x 1200mm

| Product Code | Thickness (mm) | Width (mm) | Length (mm) | Pieces/ Pallet | Area/ Pallet (m <sup>2</sup> ) | Made to Order | MOQ (Pallet) | List Price/m <sup>2</sup> |
|--------------|----------------|------------|-------------|----------------|--------------------------------|---------------|--------------|---------------------------|
| 123087       | 40             | 1200       | 2000        | 30             | 72.00                          |               |              | €107.17                   |
| 252867       | 50             | 1200       | 2000        | 24             | 57.60                          | •             | 6            | €128.56                   |
| 123090       | 90             | 1200       | 2000        | 12             | 28.80                          |               |              | €248.34                   |



Alternative sizes can be made to order. For details please contact ROCKWOOL Customer Support Centre.  
Techwrap2 orders cannot be used to contribute towards mixed loads.  
The lead times for these products can vary and will be confirmed on receipt of order.  
Additional carriage charges may apply, please contact Customer Services for information.

## LEGAL NOTICES

## General safety requirements – Building Safety Act 2022

ROCKWOOL Limited is committed to supporting specifiers, resellers and users of ROCKWOOL products for the full life cycle of the product to comply with the obligations and responsibilities set out in the Building Safety Act 2022. With regard to the general safety requirements of the Act, ROCKWOOL Limited cannot control or foresee every situation where its products might be used. We therefore strongly advise that specifiers, resellers and users contact us where use of ROCKWOOL products is contemplated in applications different from those explicitly described in the latest, relevant ROCKWOOL product datasheets; especially in applications that can be reasonably foreseen as critical to safety.

ROCKWOOL Limited reserves the right to amend the specification of its products without notice. Changes to the ROCKWOOL manufacturing process, or to pertinent regulations, may be reflected in changes to tested and certified product performance. Whilst ROCKWOOL Limited endeavours to keep its publications up to date, readers will appreciate that between publications there may be pertinent changes in the law or other developments affecting the accuracy of the information contained in our publications.

ROCKWOOL Limited does not accept responsibility for the consequences of using (including testing or certifying) its products in applications different from those explicitly described in the relevant ROCKWOOL product datasheets. Expert advice should be sought, and ROCKWOOL Limited should be contacted, where such different use is contemplated, or where the extent of any use described by ROCKWOOL Limited is in doubt.

**The ROCKWOOL Trademark**

ROCKWOOL® - our trademark

The ROCKWOOL trademark was initially registered in Denmark as a logo mark back in 1936. In 1937, it was accompanied with a word mark registration; a registration which is now extended to more than 60 countries around the world.

The ROCKWOOL trademark is one of the most important assets of the ROCKWOOL Group, and is therefore well-protected and defended by ROCKWOOL throughout the world.

If you require permission to use the ROCKWOOL logo for your business, advertising or promotion, you must apply for a Trade Mark Usage Agreement.

To apply, write to:  
[marketcom@rockwool.com](mailto:marketcom@rockwool.com)

**Trademarks**

Registered trademarks of the ROCKWOOL Group include but are not limited to:

ROCKWOOL®, RockClose®, RainScreen Duo Slab®, HardRock®, RockFloor® Flexi®, RockFall®, FirePro®, DuctRock®, BeamClad®, NyRock®

© ROCKWOOL 2025.  
All rights reserved.

**Photography and illustrations**

The product illustrations are the property of ROCKWOOL Limited and have been created for indicative purposes only.

Unless indicated below, the photography and illustrations used in this guide are the property of ROCKWOOL Limited. We reserve all rights to the usage of these images.

If you require permission to use ROCKWOOL images, you must apply for a Usage Agreement.

To apply, write to:  
[marketcom@rockwool.com](mailto:marketcom@rockwool.com)

## HEALTH &amp; SAFETY

A Material Safety Data Sheet is available and can be downloaded from [www.rockwool.com/uk](http://www.rockwool.com/uk) to assist in the preparation of risk assessments, as required by the Control of Substances Hazardous to Health Regulations (COSHH).

# Notes











April 2025

ROCKWOOL Limited

Pencoed  
Bridgend  
CF35 6NY

Tel: 00 44 1656 862 621

[customersupportcentre@rockwool.com](mailto:customersupportcentre@rockwool.com)

[www.rockwool.com/uk](http://www.rockwool.com/uk)



Version 8.01 April 2025.

© ROCKWOOL 2025. All rights reserved.